

CITY OF VANCOUVER, WASHINGTON



PLANS FOR PROPOSED COLUMBIA STREET PAVING PROJECT

MARCH 2021

BUDGET NUMBERS FOR CONSTRUCTION:

- 102-CC0167-PRJ072821-ACT00937 - ADMINISTRATION/ENG
- 102-CC0167-PRJ072821-ACT00937 - INSPECTION
- 102-CC0167-PRJ072821-ACT00937 - SURVEY
- 103-CC0167-PRJ072821-ACT00937 - CONTRACTOR PAYMENT

SHEET INDEX

	SHT. NO.	CAT. NO.	DESCRIPTION
GENERAL STREET	1	G01	COVER SHEET
	2	G02	GENERAL NOTES, ABBREVIATIONS AND LEGEND
SIGNING AND STRIPING	3-5	C01-C03	RESURFACING PLAN
STANDARD DETAILS	6-10	SS01-SS05	STRIPING PLAN
	11-12	D01-D02	STANDARD DETAILS

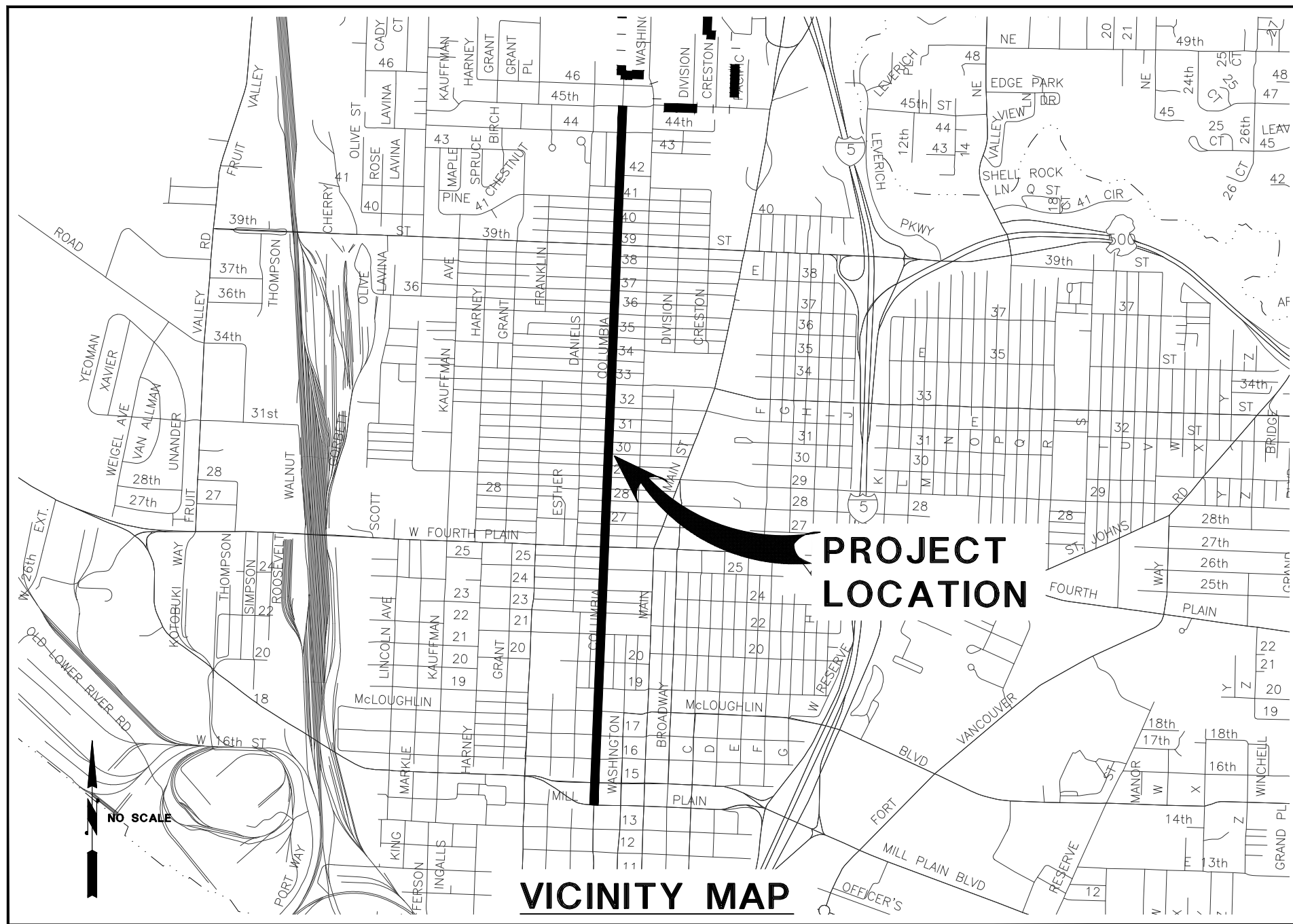

PROJECT LOCATION

VICINITY MAP



PUBLIC WORKS - TRANSPORTATION
 P.O. BOX 1995
 VANCOUVER, WA 98668-1995
 360-487-7750
 FAX: 360-487-4781

APPROVAL BY: _____
 TRAFFIC ENGINEER

APPROVAL BY: _____
 STREETS AND TRANSPORTATION MANAGER
 SHEET 1 OF 12

LEGEND

EXISTING	LINETYPE	PROPOSED	DESCRIPTION
REFERENCE LINETYPES			
---			D.L.C.
---			SUBDIV BOUNDARY
---			PRELIMINARY PLAT
---			PROPERTY LINES
---			PAVEMENT EASEMENT
---		---R/W---	RIGHT OF WAY
---		---	CENTER LINE
1+00	2+00	1+00	2+00
---			CENTER LINE TEXT
---			TRAVERSE LINE
---			TEMPORARY CONSTRUCTION PERMIT LINE
---			DIMENSION LINE

EXISTING	LINETYPE	PROPOSED	DESCRIPTION
FEATURE LINETYPES			
=====		=====	CURB/.5 OFFSET
=====		=====	CURB/CURB & GUTTER 1.0 OFFSET
=====		=====	BRIDGE
-----		-----	SIDEWALK
-----		-----	PAVED ROAD
-----		-----	GRAVEL ROAD
-----		-----	DRIVE/PARKING
o-o-o-o-o		o-o-o-o-o	GUARD RAIL
-----		-----	TRAIL
-x-x-x-x-x		-x-x-x-x-x	FENCE
~~~~~		~~~~~	TREELINE
~~~~~		~~~~~	BRUSHLINE
=====		=====	CONCRETE PAD
=====		=====	RAILROAD (4.8' OFFSET)
=====		=====	BUILDINGS
-----		-----	WATER EDGE
-----		-----	DRAINAGE DITCH
=====		=====	RETAINING WALL
-----		-----	STAIRS
-----		-----	CUT LIMITS
-----		-----	FILL LIMITS
-----		-----	C&G CLEARING AND GRUBBING

EXISTING	LINETYPE	PROPOSED	DESCRIPTION
UTILITY LINETYPES			
---		---	WATER LINE
---		---	SANITARY SEWER
---		---	STORM SEWER
---		---	POWER
---		---	TELEPHONE
---		---	GAS
---		---	CABLE TV
---		---	INTERCONNECT CONDUIT
---		---	FIBER OPTIC CONDUIT
---		---	LIGHTING
---		---	TRAFFIC SIGNAL CONDUIT
---		---	TRAFFIC SIGNAL CONDUIT FIBEROPTIC

SYMBOL EXIST.	SYMBOL PROP.	DESCRIPTION
WATER SYMBOLS		
		FIRE HYDRANT
		WATER METER
		BLOW-OFF
		WATER VALVE
		THRUST BLOCK
		CROSS
		TEE
		REDUCER
		PLUG

SYMBOL EXIST.	SYMBOL PROP.	DESCRIPTION
SEWER SYMBOLS		
		SAN. SEWER MANHOLE
		SAN. SEWER CLEAN OUT

SYMBOL EXIST.	SYMBOL PROP.	DESCRIPTION
POWER SYMBOLS		
		POWER POLE
		PAD MOUNTED TRANSFORMER
		POWER VAULT (UNDERGROUND)
		POWER VAULT (ABOVE GROUND)
		TRANSMISSION TOWER
		POLE ANCHOR

SYMBOL EXIST.	SYMBOL PROP.	DESCRIPTION
TELEPHONE SYMBOLS		
		TELEPHONE PEDESTAL
		TELEPHONE VAULT
		TELEPHONE MANHOLE

SYMBOL EXIST.	SYMBOL PROP.	DESCRIPTION
GAS SYMBOLS		
		GAS METER
		GAS VALVE

SYMBOL EXIST.	SYMBOL PROP.	DESCRIPTION
SURVEY SYMBOLS		
		SECTION CORNER
		QUARTER CORNER N/S
		QUARTER CORNER E/W
		FOUND MONUMENT
		OWNERSHIP TIE

SYMBOL EXIST.	SYMBOL PROP.	DESCRIPTION
SURFACE/LANDSCAPING SYMBOLS		
		POST
		SIGN
		SIGN POST
		CONIFER
		TREE (DECID)
		SHRUB (DECID)
		SHRUB (EVERG)
		WETLANDS
		BUS STOP
		MAIL BOX
		BOLLARD
		PARKING METER
		SOIL BORING

SYMBOL EXIST.	SYMBOL PROP.	DESCRIPTION
TRAFFIC SIGNAL INTERCONNECT AND LIGHTING SYMBOLS		
		DIAMOND DETECTOR 6X8
		QUADRAPOLE DETECTOR 20'
		QUADRAPOLE DETECTOR 50'
		SQUARE DETECTOR 6X6
		BIKE DIAMOND DETECTOR 2.4X3.2
		CIRCLE DETECTOR 6'
		SURVEILLANCE VIDEO CAMERA
		VIDEO CAMERA
		EV INDICATOR LIGHTS
		EV OPTICOM SENSOR
		PED. PUSHBUTTON (1)
		TENON
		PEDESTRIAN SIGNAL HEAD
		TRAFFIC PEDESTRIAN SIGNAL POLE
		TRAFFIC SIGNAL POLE
		VEHICLE SIGNAL HEAD
		VEHICLE SIGNAL HEAD W/ARROW INDICATOR
		SIGNAL HEAD W/PROGRAMMED VISIBILITY
		OVERHEAD SIGN ASSEMBLY
		TRAFFIC CONTROL SIGN
		SIGNAL CONTROLLER CABINET
		JUNCTION BOX (WSDOT TYPE I)
		JUNCTION BOX (WSDOT TYPE II)
		JUNCTION BOX (TYPE II-M)
		INTERCONNECT PEDESTAL
		JUNCTION BOX (WSDOT TYPE 8)
		SERVICE CABINET
		FIBEROPTIC TERMINATION CABINET
		SPLICE VAULT
		CONTACTOR CABINET
		STREET LIGHT
		YARD LIGHT

SYMBOL EXIST.	SYMBOL PROP.	DESCRIPTION
MISCELLANEOUS		
		ASPHALT PAVEMENT LIMITS
		ASPHALT PAVEMENT RESTORATION
		ASPHALT PAVEMENT RESTORATION (PLANNED AND PAVED LIMITS)
		CONCRETE SIDEWALK
		TEMPORARY ASPHALT SIDEWALK
		TRUNCATED DOME HATCH
		REMOVAL

- GENERAL NOTES:**
- DATUM IS CITY OF VANCOUVER NGVD '29.
 - ALL CONSTRUCTION AND MATERIAL, UNLESS OTHERWISE SPECIFIED, SHALL BE IN ACCORDANCE WITH THE 2021 STANDARD SPECIFICATIONS AND STANDARD PLANS FOR ROAD, BRIDGE AND MUNICIPAL CONSTRUCTION AND THE MOST CURRENT AMENDMENTS TO THESE SPECIFICATIONS AS PREPARED/ADOPTED BY WSDOT AND APWA, THE MOST CURRENT VERSION OF THE MUTCD ADOPTED BY WSDOT AND, THE COV STANDARDS AND SPECIFICATIONS.
 - EXISTING UTILITIES ARE SHOWN ON THE PLANS ACCORDING TO RECORD DRAWINGS AND SURFACE LOCATIONS. THE CONTRACTOR SHALL VERIFY LOCATION OF ALL EXISTING UTILITIES PRIOR TO CONSTRUCTION.
 - THE LIMITS OF CONSTRUCTION SHALL BE THE AREA WITHIN THERIGHT-OF-WAY OR AS INDICATED ON THE PLANS OR AS DIRECTED BY THE ENGINEER. ALL DISTURBED AREAS SHALL BE RESEEDED OR RESTORED ACCORDING TO SPECIFICATIONS.
 - AT THE END OF EACH WORKDAY THE CONTRACTOR SHALL CLEAN THE PROJECT AREA AND LEAVE IT IN A NEAT AND SECURED MANNER. UPON COMPLETION, THE CONTRACTOR SHALL LEAVE THE PROJECT AREA FREE OF DEBRIS AND UNUSED MATERIAL.
 - THE CONTRACTOR SHALL PRUNE ALL VEGETATION FOR EQUIPMENT, PEDESTRIAN OR TRAFFIC CLEARANCE AS NECESSARY AWAY AND UP FROM THE NEW SIDEWALK TO ANSI A-300 PRUNING STANDARDS AND ISA PRUNING GUIDELINES BY WASHINGTON STATE REGISTERED TREE CARE FIRM EMPLOYING ISA CERTIFIED ARBORISTS AS DIRECTED BY THE ENGINEER. LIMIT ACTIVITY WITHIN THE DRIP LINE OF TREES, NO GRADING, TRENCHING OR EQUIPMENT STORED THERE. ALL WORK WITHIN DRIP LINE SHALL BE BY HAND. IF ROOTS ARE ENCOUNTERED, ROOT PRUNE AND CUT CLEANLY WITH A HANDSAW. DO NOT RIP OR SHATTER ROOTS. REMOVE STUMPS OF REMOVED TREES. THE CONTRACTOR SHALL PROTECT ALL EXISTING LANDSCAPING THAT IS TO REMAIN.
 - CONTRACTOR SHALL NOTIFY OTHER PUBLIC UTILITIES (GAS, PHONE, ELECTRIC, CABLE TV, ETC.) TO MAKE ALL NECESSARY ADJUSTMENTS TO RESPECTIVE FACILITIES.
 - ALL PEDESTRIAN RAMPS SHALL BE CITY STANDARD, UNLESS DIRECTED OTHERWISE BY THE ENGINEER.
 - STRIPING AND SIGNING WORK, UNLESS OTHERWISE NOTED, SHALL BE COMPLETED BY THE CONTRACTOR. THE CONTRACTOR SHALL COORDINATE THIS WORK WITH THE ENGINEER. TEMPORARY SIGNING SHALL BE INSTALLED BY THE CONTRACTOR, AS REQUIRED AND DIRECTED BY THE ENGINEER.
 - TRAFFIC CONTROL SHALL BE IN ACCORDANCE WITH THE CURRENT MANUAL ON UNIFORM TRAFFIC CONTROL DEVICES. IT SHALL BE SUBJECT TO THE APPROVAL OF THE CITY OF VANCOUVER ENGINEER, AND SECTION 1-10 TRAFFIC CONTROL OF THE SPECIFICATION.
 - CURB RETURN ELEVATIONS GIVEN ARE AT TOP OF CURB, UNLESS OTHERWISE NOTED.
 - THE CONTRACTOR SHALL MAKE EVERY REASONABLE EFFORT TO PROTECT THE REMAINING EXISTING CONCRETE CURBS AND SIDEWALKS AS INDICATED ON THE PLANS.
 - SIDEWALK WIDTHS FOR PAYMENT ARE MEASURED FROM BACK OF CURB TO THE BACK OF SIDEWALK, AND HAVE A 2% CROSS SLOPE.
 - THE CONTRACTOR SHALL PERFORM ALL EROSION CONTROL WORK IN ACCORDANCE TO THE CITY OF VANCOUVER EROSION CONTROL ORDINANCE, SECTION VMC 14.24. SLURRY AND CUTTINGS SHALL BE VACUUMED DURING CUTTING AND SURFACING OPERATIONS. SLURRY AND CUTTINGS SHALL BE DISPOSED OF IN A MANNER THAT DOES NOT VIOLATE GROUNDWATER OR SURFACE WATER QUALITY STANDARDS.
 - TRACKING ON ROADWAYS SHALL BE CLEANED THOROUGHLY AT THE END OF EACH DAY, WITH A HIGH EFFICIENCY SWEEPER OR MORE OFTEN IF NECESSARY SIGNIFICANT SOIL DEPOSIT SHALL BE REMOVED FROM ROADS BY SHOVELING OR SWEEPING AND SHALL BE TRANSPORTED TO A CONTROLLED SEDIMENT DISPOSAL AREA. TRENCHES SHALL BE TOPPED AND MAINTAINED WITH CLEAN ROCK UNTIL PAVING OCCURS.
 - ALL MATERIAL SHALL BE PROVIDED BY CONTRACTOR UNLESS OTHERWISE SPECIFIED.
 - PROTECT EXISTING CATCH BASIN OR CURB INLET. SEE "INLET PROTECTION" DETAIL ON SHEET D02.

CALL 2 BUSINESS DAYS BEFORE YOU DIG 1-800-424-5555 "It's the Law" CLARK COUNTY UTILITIES COORDINATING COUNCIL

PUBLIC WORKS TRANSPORTATION
P.O. BOX 1995
VANCOUVER, WA 98668-1995
360-487-7750
FAX: 360-487-4781

SCALE	DATE	DESIGNED BY	DRAWN BY	CHECKED BY	APPROVED BY	REVISIONS
HORIZONTAL: 1"=40'	MARCH 2021					
VERTICAL: 1"=4'						

DATE	NO.	REVISIONS

COLUMBIA STREET PAVING PROJECT

GENERAL NOTES ABBREVIATIONS AND LEGEND

PROJECT NUMBER: **072821**

ACTIVITY CODE: **ACT00937**

G02

SHEET **2** OF **12**

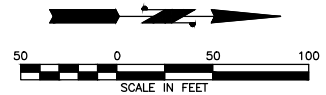
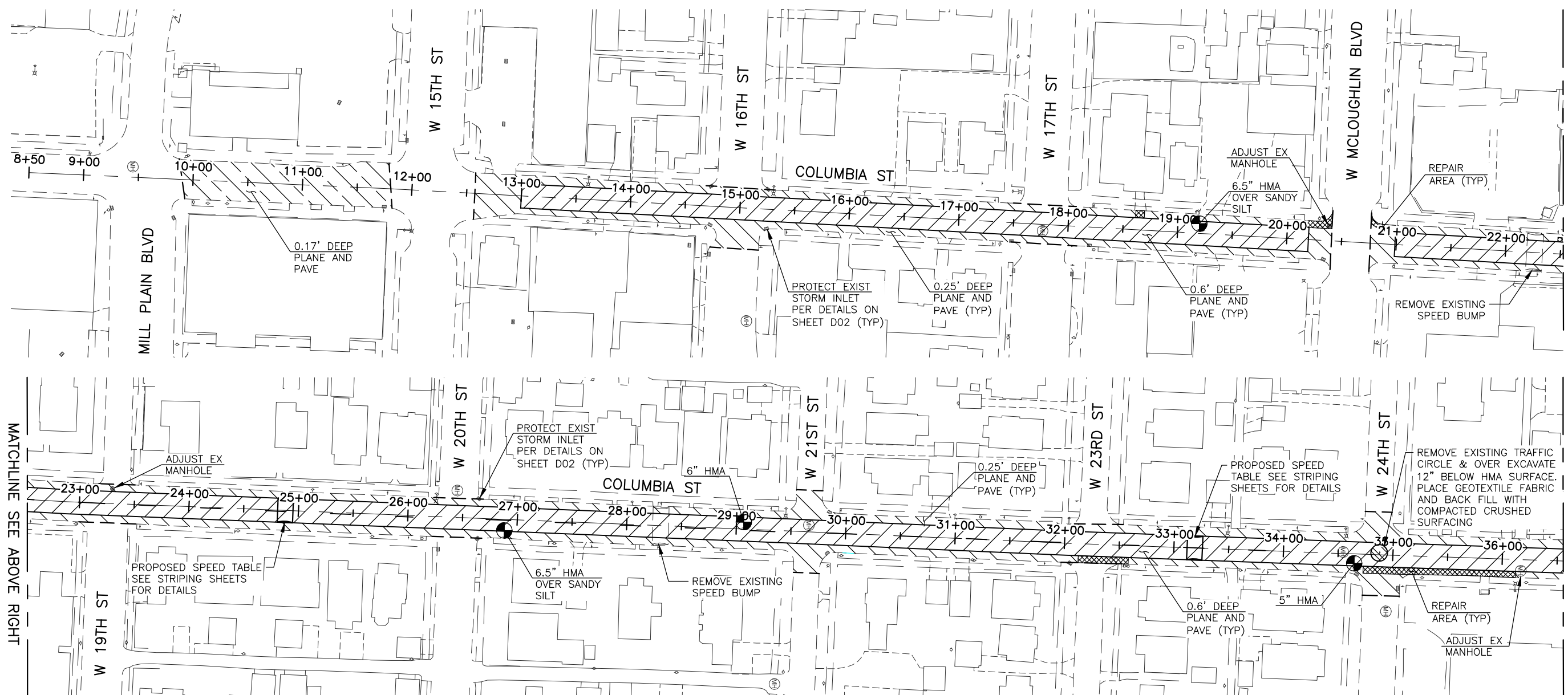

APPROXIMATE CORE HOLE LOCATION HMA DEPTH AND GRAVEL DEPTH IF MEASURED

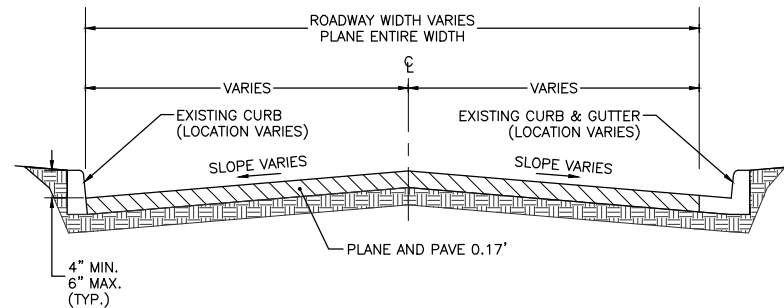

TYPICAL FULL WIDTH PLANE AND PAVE
MILL PLAIN BLVD TO W 15TH ST
NOT TO SCALE

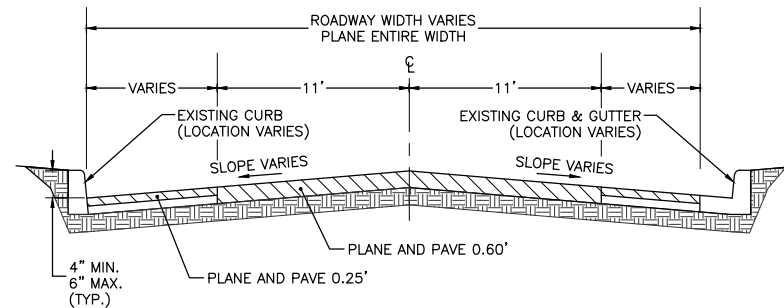

TYPICAL FULL WIDTH PLANE AND PAVE
MILL PLAIN BLVD TO W 33RD ST
NOT TO SCALE

RESURFACING, ADJUSTMENT AND INSTALLATION QUANTITIES

STREET NAME	LENGTH (LF)	AREA (SY)	PLANING ROADWAY MATERIALS (SY)	PVMNT REPAIR (\$Y)	PVMNT REPAIR (TON)	HMA TYPE (1,2)	HMA DEPTH (FT)	HMA QUANT (TON)	ADJUST CATCH BASIN (EA)	ADJUST MANHOLE (EA)
W COLUMBIA ST										
Mill Plain Blvd to W 45th St	8,260	10,985	10,985			2	0.60	4,300		5
		15,085	15,085			2	0.40	3,935		
		8,990	8,990	430	170	2	0.25	1,465		
		775	775			2	0.17	90		
TOTALS FOR SHEETS C01-C03	8,260	35,060	35,060	430	170			9,790		

NOTES:
This tabulation is for bidder's convenience and is informational only. Quantities on each section may vary as well as the total for all sections.
This tabulation does not include all bid items occurring on each section. See plan view, notes and proposal for totals for all bid items in the project.
Locations shall be marked in the field by the Engineer.
HMA Type "1" = HMA Class 3/8" PG 58V-22, HMA Type "2" = HMA Class 3/8" PG 58H-22

- NOTE:
- CONTRACTOR SHOULD ANTICIPATE ENCOUNTERING SILT, SAND, GRAVEL AND COBBLES DURING PLANING.
 - PAVEMENT REPAIRS SHALL EXTEND TO THE SUBGRADE IMMEDIATELY BELOW THE PAVEMENT. IF SUBGRADE IS LOOSE OR SOFT, ADDITIONAL EXCAVATION MAY BE REQUIRED.

- 0.60' PLANE & PAVE
- 0.40' PLANE & PAVE
- 0.25' PLANE & PAVE
- 0.17' PLANE & PAVE
- REPAIR AREA
- OVER EXCAVATION AREA

CALL 2 BUSINESS DAYS BEFORE YOU DIG 1-800-424-5555 "It's the Law" CLARK COUNTY UTILITIES COORDINATING COUNCIL



PUBLIC WORKS TRANSPORTATION P.O. BOX 1995 VANCOUVER, WA 98668-1995 360-487-7750 FAX: 360-487-4781

DATE: MARCH 2021	DESIGNED BY: CAS
DRAWN BY: DJM	CHECKED BY: CAS
APPROVED BY:	REVISIONS:

DRAWING NUMBER: C01-C03.DWG	SCALE:
HORIZONTAL:	VERTICAL:
DATE:	No.:

COLUMBIA STREET PAVING PROJECT

RESURFACING PLAN

PROJECT NUMBER **072821**
ACTIVITY CODE **ACT00937**
C01
SHEET **3** OF **12**

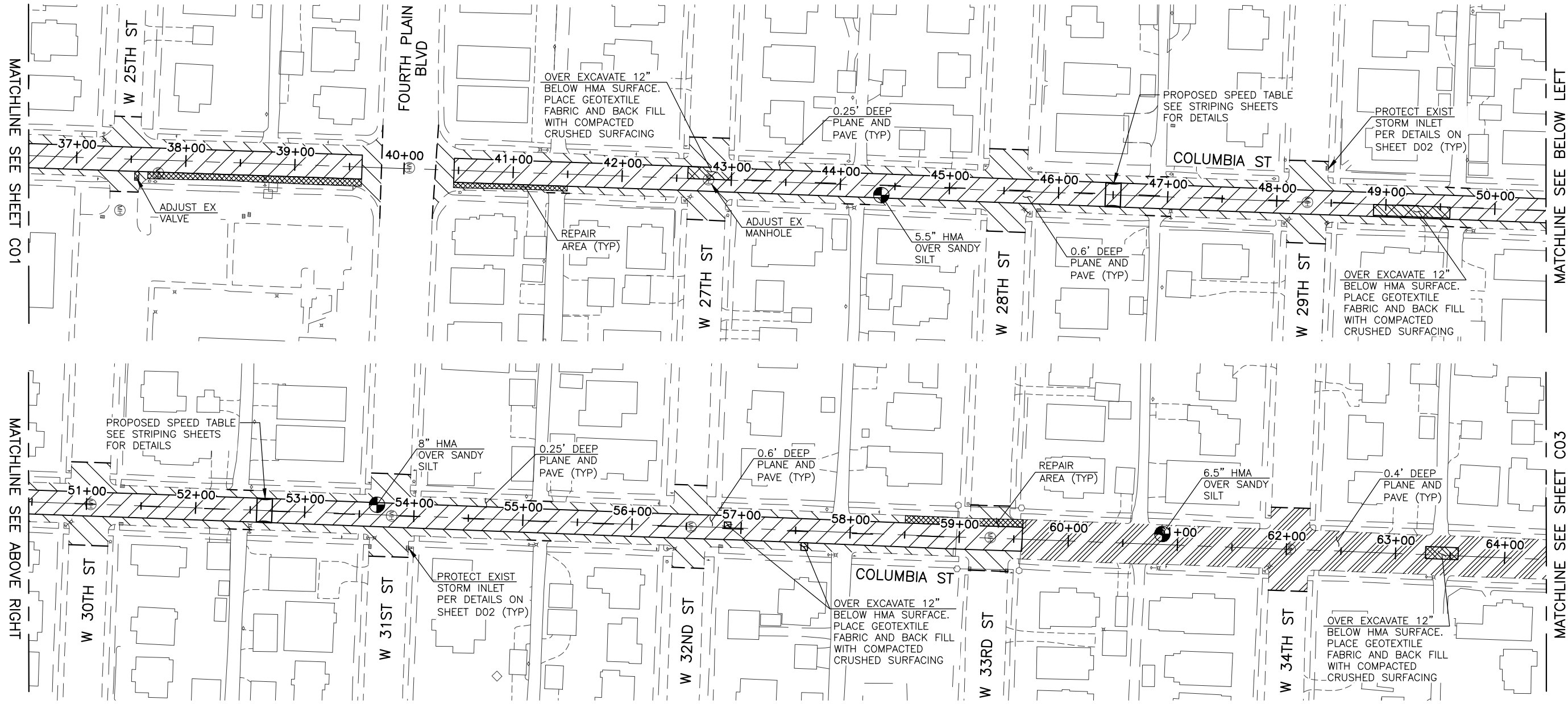

MATCHLINE SEE ABOVE RIGHT

MATCHLINE SEE SHEET C01

MATCHLINE SEE BELOW LEFT

MATCHLINE SEE SHEET C03

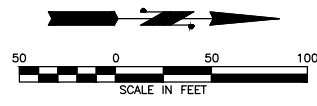

APPROXIMATE CORE HOLE LOCATION HMA DEPTH AND GRAVEL DEPTH IF MEASURED

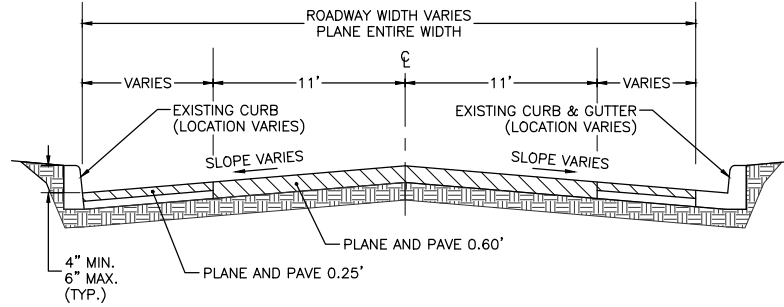

TYPICAL FULL WIDTH PLANE AND PAVE
MILL PLAIN BLVD TO W 33RD ST
NOT TO SCALE

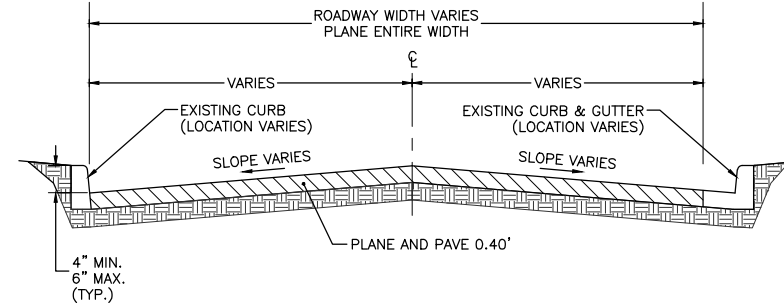

TYPICAL FULL WIDTH PLANE AND PAVE
W 33RD ST TO W 45TH ST
NOT TO SCALE

- NOTE:
- CONTRACTOR SHOULD ANTICIPATE ENCOUNTERING SILT, SAND, GRAVEL AND COBBLES DURING PLANING.
 - PAVEMENT REPAIRS SHALL EXTEND TO THE SUBGRADE IMMEDIATELY BELOW THE PAVEMENT. IF SUBGRADE IS LOOSE OR SOFT, ADDITIONAL EXCAVATION MAY BE REQUIRED.

RESURFACING, ADJUSTMENT AND INSTALLATION QUANTITIES

STREET NAME	LENGTH (LF)	AREA (SY)	PLANING ROADWAY MATERIALS (SY)	PVMNT REPAIR (SY)	PVMNT REPAIR (TON)	HMA TYPE (1,2)	HMA DEPTH (FT)	HMA QUANT (TON)	ADJUST CATCH BASIN (EA)	ADJUST MANHOLE (EA)
W COLUMBIA ST										
Mill Plain Blvd to W 45th St	8,260	10,985	10,985			2	0.60	4,300		5
		15,085	15,085			2	0.40	3,935		
		8,990	8,990	430	170	2	0.25	1,465		
		775	775			2	0.17	90		
TOTALS FOR SHEETS C01-C03	8,260	35,060	35,060	430	170			9,790		

NOTES:
This tabulation is for bidder's convenience and is informational only. Quantities on each section may vary as well as the total for all sections.
This tabulation does not include all bid items occurring on each section. See plan view, notes and proposal for totals for all bid items in the project.
Locations shall be marked in the field by the Engineer.
HMA Type "1" = HMA Class 3/8" PG 58V-22, HMA Type "2" = HMA Class 3/8" PG 58H-22

- 0.60' PLANE & PAVE
- 0.40' PLANE & PAVE
- 0.25' PLANE & PAVE
- 0.17' PLANE & PAVE
- REPAIR AREA
- OVER EXCAVATION AREA

CALL 2 BUSINESS DAYS BEFORE YOU DIG 1-800-424-5555 "It's the Law" CLARK COUNTY UTILITIES COORDINATING COUNCIL

PUBLIC WORKS TRANSPORTATION
P.O. BOX 1995
VANCOUVER, WA 98668-1995
360-487-7750
FAX: 360-487-4781

DRAWING NUMBER: C01-C03.DWG	DATE: MARCH 2021
DESIGNED BY: CAS	DRAWN BY: DJM
CHECKED BY: CAS	APPROVED BY:
SCALE: HORIZONTAL: VERTICAL:	REVISIONS:
DATE: No.	

COLUMBIA STREET PAVING PROJECT

RESURFACING PLAN

PROJECT NUMBER **072821**
ACTIVITY CODE **ACT00937**
C02

SHEET **4** OF **12**

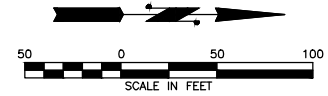
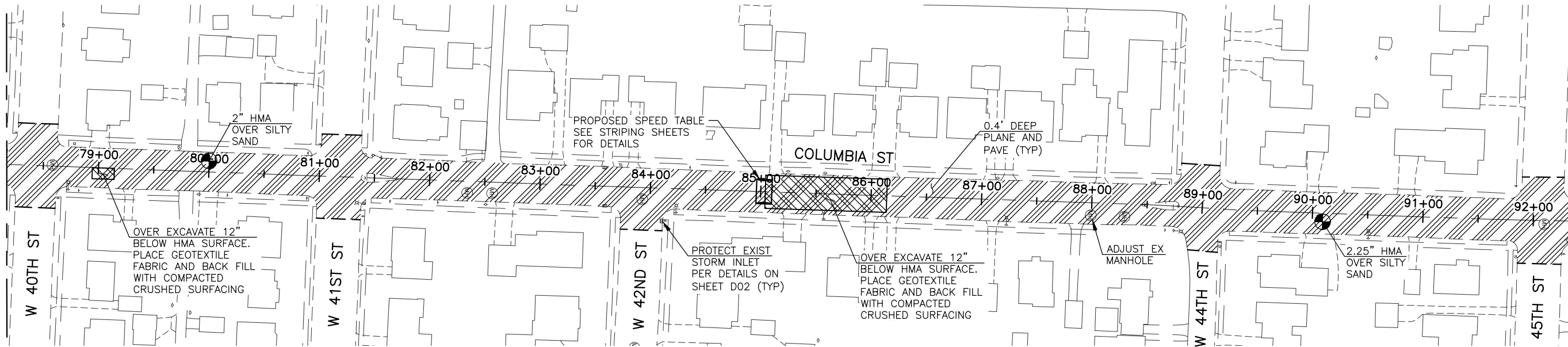
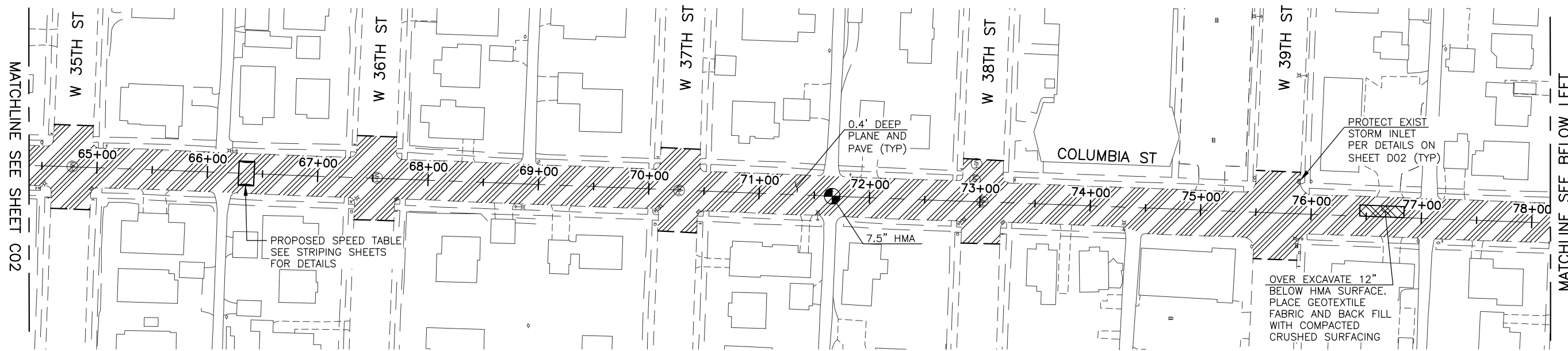

APPROXIMATE CORE HOLE LOCATION HMA DEPTH AND GRAVEL DEPTH IF MEASURED

- NOTE:**
- CONTRACTOR SHOULD ANTICIPATE ENCOUNTERING SILT, SAND, GRAVEL AND COBBLES DURING PLANING.
 - PAVEMENT REPAIRS SHALL EXTEND TO THE SUBGRADE IMMEDIATELY BELOW THE PAVEMENT. IF SUBGRADE IS LOOSE OR SOFT, ADDITIONAL EXCAVATION MAY BE REQUIRED.

RESURFACING, ADJUSTMENT AND INSTALLATION QUANTITIES

STREET NAME	LENGTH (LF)	AREA (SY)	PLANING ROADWAY MATERIALS (SY)	PVMNT REPAIR (\$Y)	PVMNT REPAIR (TON)	HMA TYPE (1,2)	HMA DEPTH (FT)	HMA QUANT (TON)	ADJUST CATCH BASIN (EA)	ADJUST MANHOLE (EA)
W COLUMBIA ST										
Mill Plain Blvd to W 45th St	8,260	10,985	10,985			2	0.60	4,300		5
		15,085	15,085			2	0.40	3,935		
		8,990	8,990	430	170	2	0.25	1,465		
		775	775			2	0.17	90		
TOTALS FOR SHEETS C01-C03	8,260	35,060	35,060	430	170			9,790		

NOTES:
 This tabulation is for bidder's convenience and is informational only. Quantities on each section may vary as well as the total for all sections.
 This tabulation does not include all bid items occurring on each section. See plan view, notes and proposal for totals for all bid items in the project.
 Locations shall be marked in the field by the Engineer.
 HMA Type "1" = HMA Class 3/8" PG 58V-22, HMA Type "2" = HMA Class 3/8" PG 58H-22

- 0.60' PLANE & PAVE
- 0.40' PLANE & PAVE
- 0.25' PLANE & PAVE
- 0.17' PLANE & PAVE
- REPAIR AREA
- OVER EXCAVATION AREA

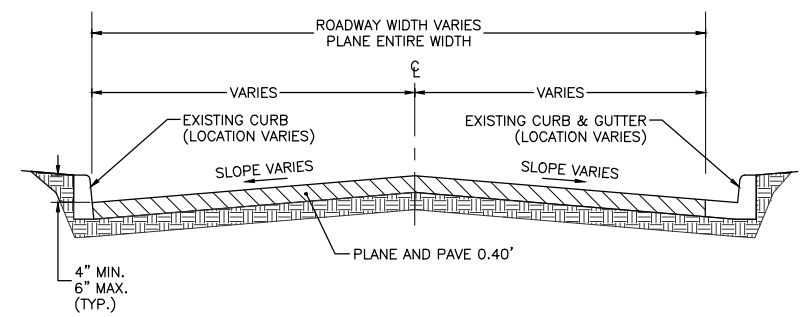

TYPICAL FULL WIDTH PLANE AND PAVE
 W 33RD ST TO W 45TH ST
 NOT TO SCALE

CALL
 2 BUSINESS DAYS
 BEFORE YOU DIG
 1-800-424-5555
 "It's the Law"
 CLARK COUNTY UTILITIES COORDINATING COUNCIL



PUBLIC WORKS
 TRANSPORTATION
 P.O. BOX 1995
 VANCOUVER, WA
 98668-1995
 360-487-7750
 FAX: 360-487-4781

DATE: MARCH 2021	DESIGNED BY: CAS
DRAWING NUMBER: C01-C03.DWG	DRAWN BY: DJM
SCALE: HORIZONTAL: VERTICAL:	CHECKED BY: CAS
DATE: No.	APPROVED BY:
	REVISIONS

**COLUMBIA STREET
 PAVING PROJECT
 RESURFACING PLAN**

PROJECT NUMBER
072821
 ACTIVITY CODE
ACT00937
C03
 SHEET **5** OF **12**

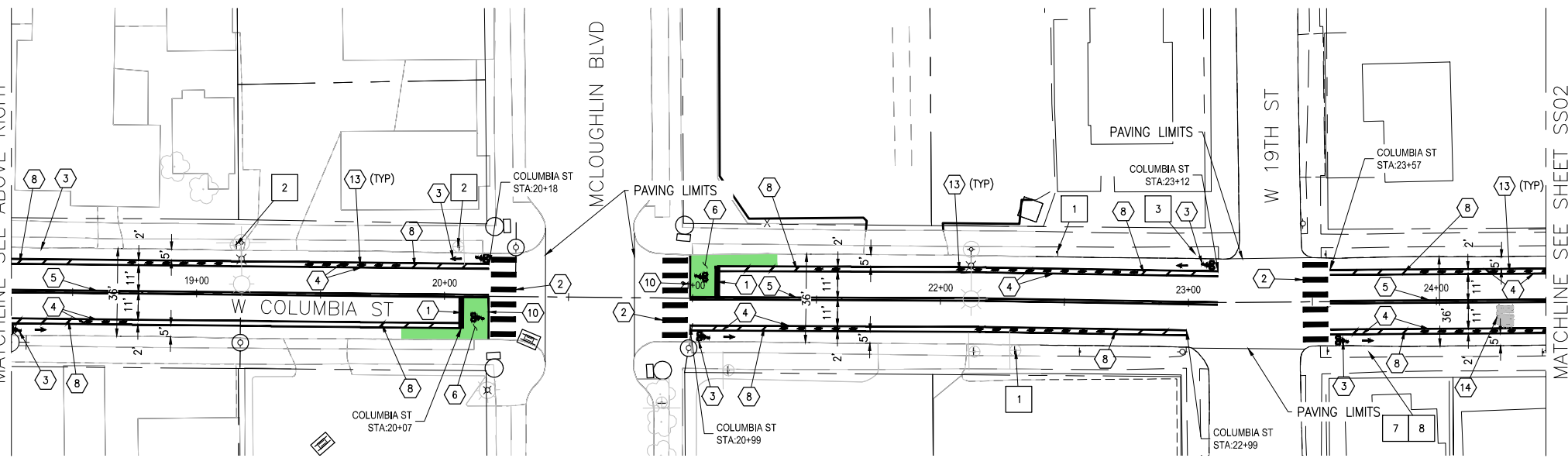
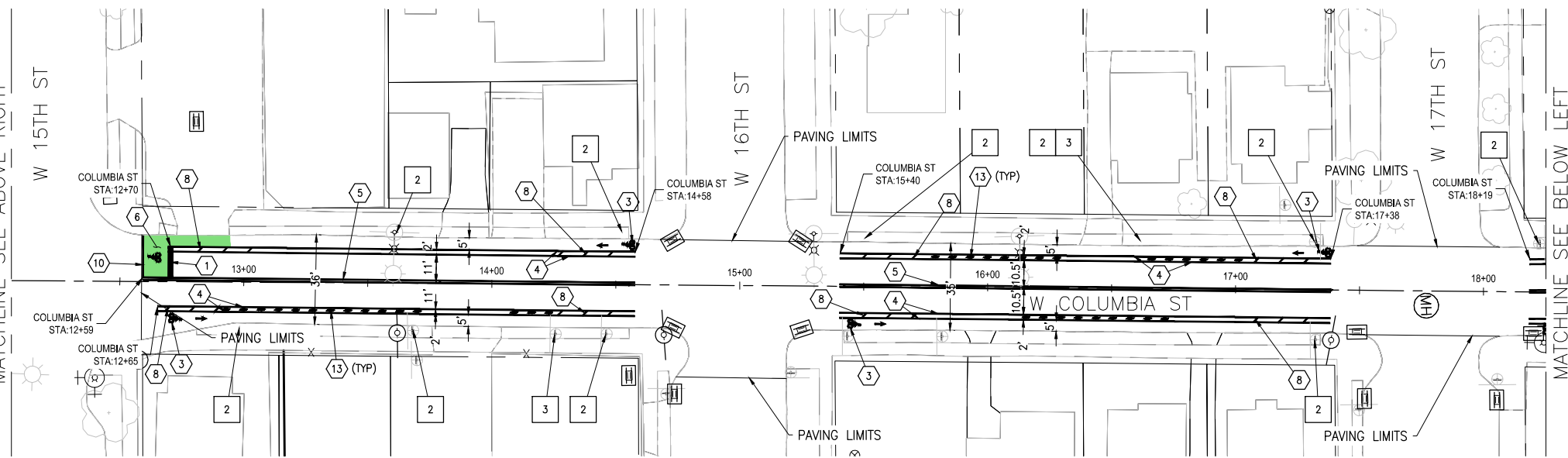
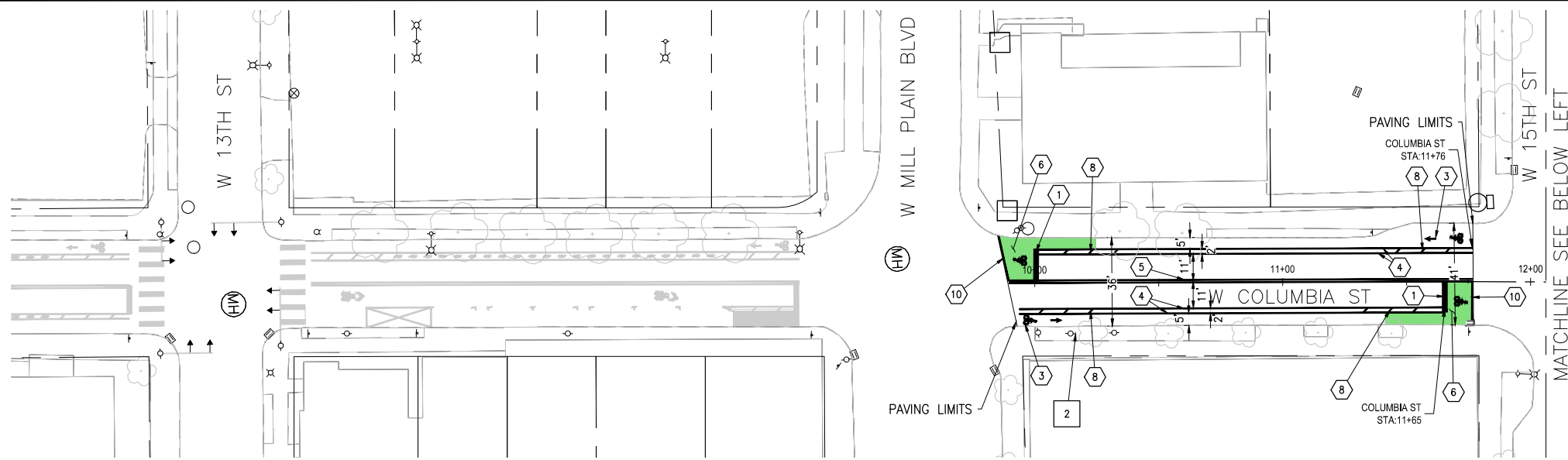

CONSTRUCTION NOTES

- ① THERMOPLASTIC STOP BAR, 24" WHITE, SEE DETAIL T29-40.
 - ② THERMOPLASTIC STANDARD CROSSWALK, SEE DETAIL T29-41.
 - ③ THERMOPLASTIC BICYCLE LANE MARKING, WHITE, SEE DETAIL T29-43.
 - ④ PAINTED BIKE LANE BUFFER ZONE, 8" ADJACENT TO TRAFFIC LANE, AND 4" ADJACENT TO BIKE LANE, SEE DETAIL T29-43.
 - ⑤ PAINTED DOUBLE YELLOW CENTER LINE MARKINGS, 4" YELLOW, SEE DETAIL T29-48.
 - ⑥ BIKE BOX, BY OTHERS.
 - ⑦ NOT USED, THIS SHEET.
 - ⑧ THERMOPLASTIC BIKE LANE BUFFER ZONE AREA MARKING. SEE DETAIL T29-43.
 - ⑨ NOT USED, THIS SHEET.
 - ⑩ PAINTED BIKE EDGE LINE, 4" WHITE, BY OTHERS.
 - ⑪ NOT USED, THIS SHEET.
 - ⑫ NOT USED, THIS SHEET.
 - ⑬ CYCLE LANE SEPARATOR, BY OTHERS.
 - ⑭ THERMOPLASTIC BUMP LEGEND, SEE DETAIL T29-42.
 - ⑮ NOT USED, THIS SHEET.
 - ⑯ NOT USED, THIS SHEET.
- SEE SHEET D01 FOR DETAILS.

SIGNAGE AND CONSTRUCTION NOTES:

- ① REMOVE EXISTING BUMP WARNING SIGN, ADVISORY SPEED SIGN, AND POST. RELOCATE AND REUSE PER NOTE 7 AND 8 IF POSSIBLE.
- ② REMOVE EXISTING PARKING SIGN. PROTECT ANY ADDITIONAL SIGNS AND POST.
- ③ REMOVE EXISTING "BICYCLE MAY USE FULL LANE", PROTECT ANY ADDITIONAL SIGNS AND POST.
- ④ NOT USED, THIS SHEET.
- ⑤ NOT USED, THIS SHEET.
- ⑥ NOT USED, THIS SHEET.
- ⑦ BUMP WARNING SIGN (W8-1) PER MUTCD. SEE SIGN TABLE ON SHEET D01 FOR ADDITIONAL INFORMATION.
- ⑧ BUMP 20 MPH ADVISORY SPEED PLAQUE (W13-1P) PER MUTCD. SEE SIGN TABLE ON SHEET D01 FOR ADDITIONAL INFORMATION.

NOTES:

- 1. ALL STATIONING BEYOND 61+00, IS APPROXIMATE.
- 2. DETAIL T02-26A MODIFICATION. THE EDGE OF THE SPEED TABLES SHALL END IN THE MIDDLE OF THE BIKE BUFFER.
- 3. EXISTING SIGNS SHALL BE PROTECTED UNLESS OTHERWISE NOTED.
- 4. CONTRACTOR SHALL CALL FOR UTILITY LOCATES PRIOR TO INSTALLATION OF ANY SIGNS.
- 5. EXISTING PARKING METERS TO BE REMOVED BY OTHERS.

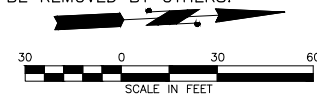

Otak, Inc.
 700 Washington St., Suite 300
 Vancouver, WA 98660
 360.737.9613
 www.otak.com



CALL
 2 BUSINESS DAYS
 BEFORE YOU DIG
 1-800-424-5555
 "It's the Law"
 CLARK COUNTY UTILITIES COORDINATING COUNCIL



PUBLIC WORKS
 TRANSPORTATION
 P.O. BOX 1995
 VANCOUVER, WA
 98668-1995
 360-487-7750
 FAX: 360-487-4781

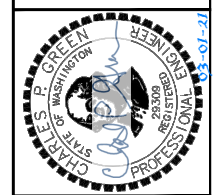

DRAWING NUMBER: SS00-SS03.DWG	DATE: MARCH 2021
DESIGNED BY: CFG	DRAWN BY: RMS
CHECKED BY: PJH	APPROVED BY: CFG
SCALE: HORIZONTAL: AS SHOWN VERTICAL:	
REVISIONS	
DATE	No.

COLUMBIA STREET PAVING PROJECT
 13TH ST. TO 45TH ST.
 STRIPING PLANS
 13TH - 19TH
 PROJECT NUMBER
 072821
 ACTIVITY CODE
 ACT0937
 SS01
 SHEET 6 OF 12



CONSTRUCTION NOTES

- ① THERMOPLASTIC STOP BAR, 24" WHITE, SEE DETAIL T29-40.
 - ② THERMOPLASTIC STANDARD CROSSWALK, SEE DETAIL T29-41.
 - ③ THERMOPLASTIC BICYCLE LANE MARKING, WHITE, SEE DETAIL T29-43.
 - ④ PAINTED BIKE LANE BUFFER ZONE, 8" ADJACENT TO TRAFFIC LANE, AND 4" ADJACENT TO BIKE LANE, SEE DETAIL T29-43.
 - ⑤ PAINTED DOUBLE YELLOW CENTER LINE MARKINGS, 4" YELLOW, SEE DETAIL T29-48.
 - ⑥ BIKE BOX, BY OTHERS.
 - ⑦ NOT USED, THIS SHEET.
 - ⑧ THERMOPLASTIC BIKE LANE BUFFER ZONE AREA MARKING. SEE DETAIL T29-43.
 - ⑨ NOT USED, THIS SHEET.
 - ⑩ PAINTED BIKE EDGE LINE, 4" WHITE, BY OTHERS
 - ⑪ GRIND TO REMOVE AND REINSTALL THERMOPLASTIC STANDARD CROSSWALK BEYOND PAVING LIMITS, SEE DETAIL T29-41.
 - ⑫ NOT USED, THIS SHEET.
 - ⑬ CYCLE LANE SEPARATOR, BY OTHERS.
 - ⑭ THERMOPLASTIC BUMP LEGEND, SEE DETAIL T29-42.
 - ⑮ CONSTRUCT SPEED TABLE, WITH THERMOPLASTIC TRIANGLE SPEED BUMP LEGEND, SEE DETAIL T29-42 AND DETAIL ON SHEET D01.
 - ⑯ NOT USED, THIS SHEET.
- SEE SHEET D01 FOR DETAILS.

SIGNAGE AND CONSTRUCTION NOTES:

- 1 REMOVE EXISTING BUMP WARNING SIGN, ADVISORY SPEED SIGN, AND POST. RELOCATE AND REUSE PER NOTE 7 AND 8 IF POSSIBLE.
- 2 REMOVE EXISTING PARKING SIGN. PROTECT ANY ADDITIONAL SIGNS AND POST.
- 3 REMOVE EXISTING "BICYCLE MAY USE FULL LANE", PROTECT ANY ADDITIONAL SIGNS AND POST.
- 4 REMOVE EXISTING "BIKE LANE ENDS" SIGN.
- 5 REMOVE EXISTING BUMP WARNING SIGN AND POST.
- 6 NOT USED, THIS SHEET.
- 7 BUMP WARNING SIGN (W8-1) PER MUTCD. SEE SIGN TABLE ON SHEET D01 FOR ADDITIONAL INFORMATION.
- 8 BUMP 20 MPH ADVISORY SPEED PLAQUE (W13-1P) PER MUTCD. SEE SIGN TABLE ON SHEET D01 FOR ADDITIONAL INFORMATION.

NOTES:

- 1. ALL STATIONING BEYOND 61+00, IS APPROXIMATE.
- 2. DETAIL T02-26A MODIFICATION. THE EDGE OF THE SPEED TABLES SHALL END IN THE MIDDLE OF THE BIKE BUFFER.
- 3. EXISTING SIGNS SHALL BE PROTECTED UNLESS OTHERWISE NOTED.
- 4. CONTRACTOR SHALL CALL FOR UTILITY LOCATES PRIOR TO INSTALLATION OF ANY SIGNS.

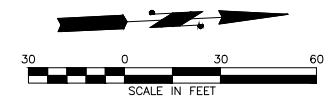

Otak, Inc.
 700 Washington St., Suite 300
 Vancouver, WA 98660
 360.737.9613
 www.otak.com

CALL
 2 BUSINESS DAYS
 BEFORE YOU DIG
 1-800-424-5555
 "It's the Law"
 CLARK COUNTY UTILITIES COORDINATING COUNCIL



PUBLIC WORKS
 TRANSPORTATION
 P.O. BOX 1995
 VANCOUVER, WA
 98668-1995
 360-487-7750
 FAX: 360-487-4781



DRAWING NUMBER: SS00-SS03.DWG	DATE: MARCH 2021
DESIGNED BY: CPG	CHECKED BY: PJH
DRAWN BY: RMS	APPROVED BY: CPG
HORIZONTAL: AS SHOWN	REVISIONS
VERTICAL:	DATE
	No.

COLUMBIA STREET PAVING PROJECT
 13TH ST. TO 45TH ST.
 STRIPING PLANS
 19TH - 27TH

PROJECT NUMBER
 072821
 ACTIVITY CODE
 ACT00937
 SS02
 SHEET 7 OF 12

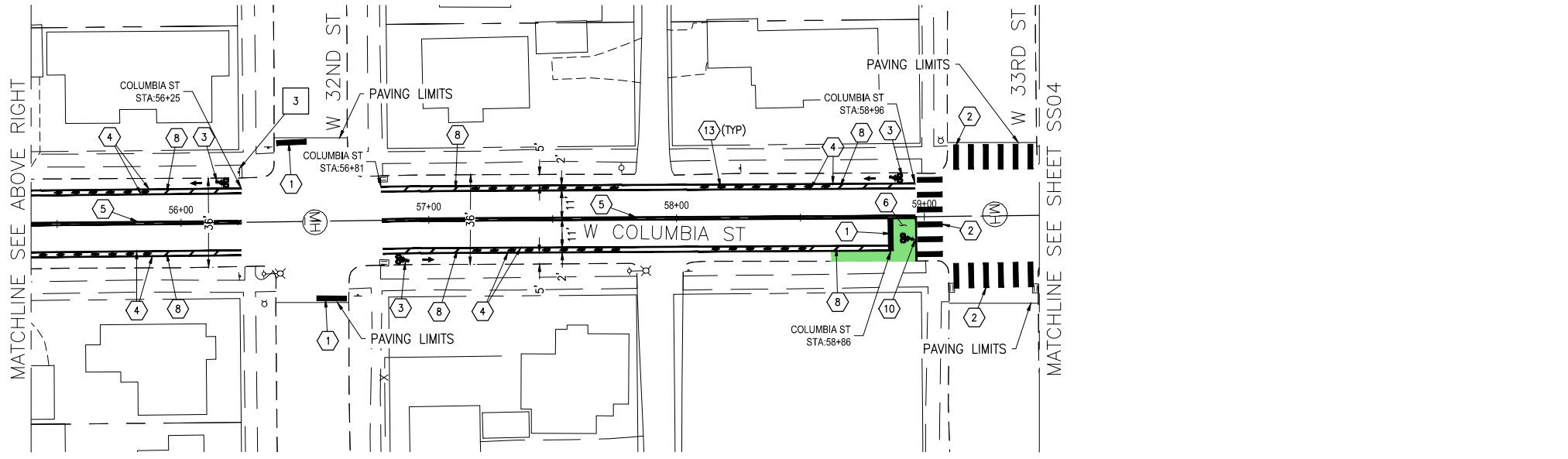
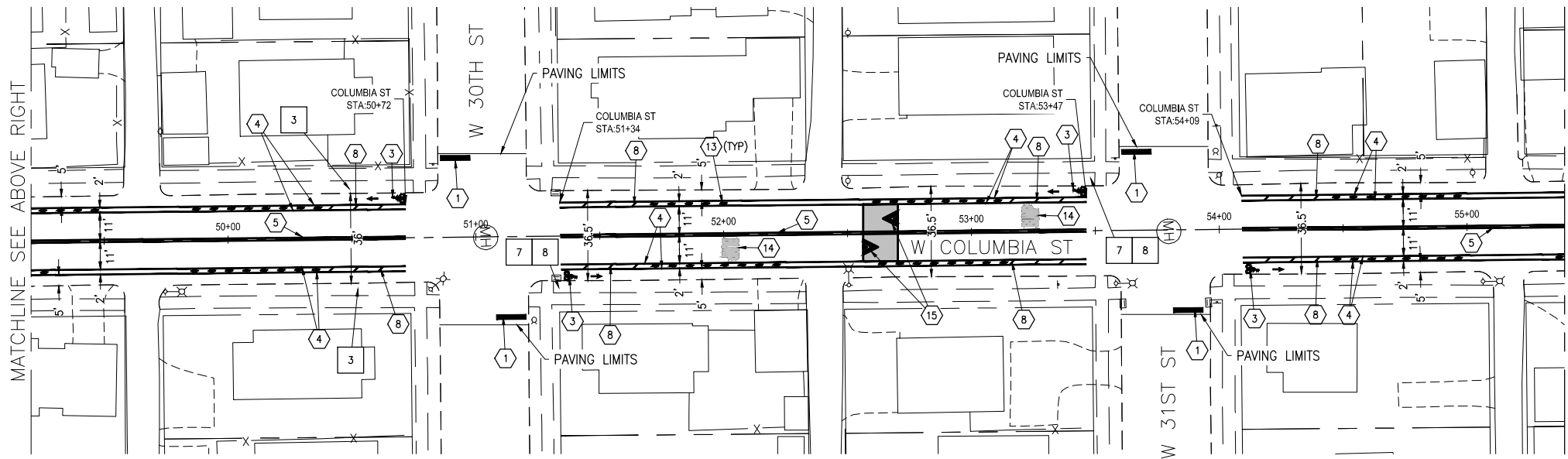
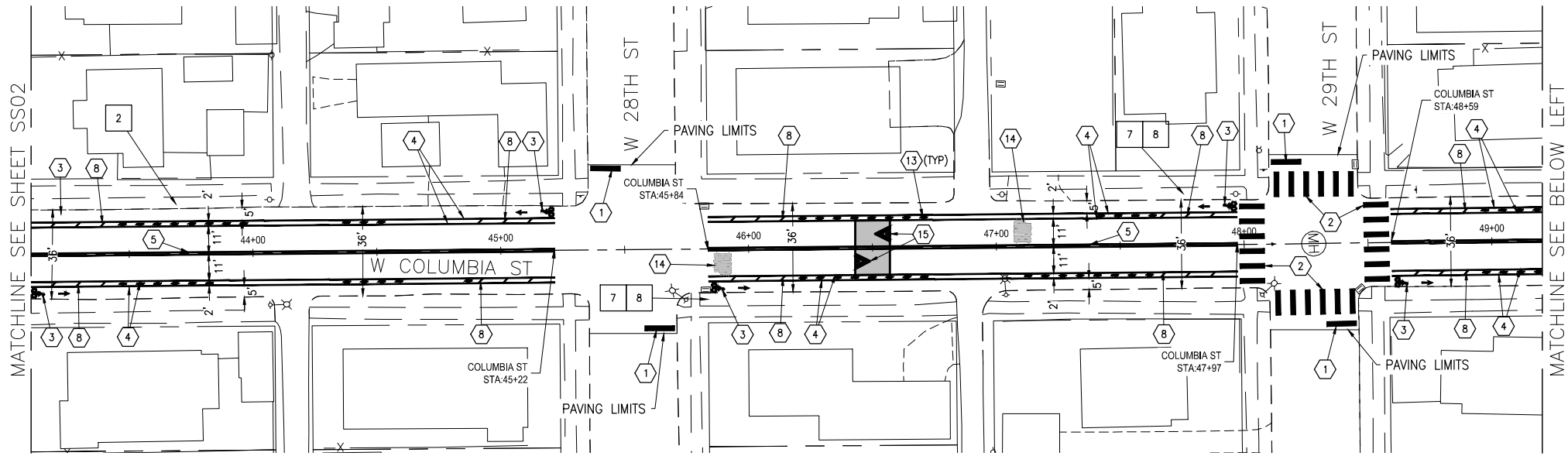

CONSTRUCTION NOTES

- ① THERMOPLASTIC STOP BAR, 24" WHITE, SEE DETAIL T29-40.
 - ② THERMOPLASTIC STANDARD CROSSWALK, SEE DETAIL T29-41.
 - ③ THERMOPLASTIC BICYCLE LANE MARKING, WHITE, SEE DETAIL T29-43.
 - ④ PAINTED BIKE LANE BUFFER ZONE, 8" ADJACENT TO TRAFFIC LANE, AND 4" ADJACENT TO BIKE LANE, SEE DETAIL T29-43.
 - ⑤ PAINTED DOUBLE YELLOW CENTER LINE MARKINGS, 4" YELLOW, SEE DETAIL T29-48.
 - ⑥ BIKE BOX, BY OTHERS.
 - ⑦ NOT USED, THIS SHEET.
 - ⑧ THERMOPLASTIC BIKE LANE BUFFER ZONE AREA MARKING. SEE DETAIL T29-43.
 - ⑨ NOT USED, THIS SHEET.
 - ⑩ PAINTED BIKE EDGE LINE, 4" WHITE, BY OTHERS.
 - ⑪ NOT USED, THIS SHEET.
 - ⑫ NOT USED, THIS SHEET.
 - ⑬ CYCLE LANE SEPARATOR, BY OTHERS
 - ⑭ THERMOPLASTIC BUMP LANE MARKING, SEE DETAIL T29-42.
 - ⑮ CONSTRUCT SPEED TABLE, WITH THERMOPLASTIC TRIANGLE SPEED BUMP LEGEND, SEE DETAIL T29-42 AND DETAIL ON SHEET D01.
 - ⑯ NOT USED, THIS SHEET.
- SEE SHEET D01 FOR DETAILS.

SIGNAGE AND CONSTRUCTION NOTES:

- 1 NOT USED, THIS SHEET.
- 2 REMOVE EXISTING PARKING SIGN. PROTECT ANY ADDITIONAL SIGNS AND POST.
- 3 REMOVE EXISTING "BICYCLE MAY USE FULL LANE", PROTECT ANY ADDITIONAL SIGNS AND POST.
- 4 NOT USED, THIS SHEET.
- 5 NOT USED, THIS SHEET.
- 6 NOT USED, THIS SHEET.
- 7 BUMP WARNING SIGN (W8-1) PER MUTCD. SEE SIGN TABLE ON SHEET D01 FOR ADDITIONAL INFORMATION.
- 8 BUMP 20 MPH ADVISORY SPEED PLAQUE (W13-1P) PER MUTCD. SEE SIGN TABLE ON SHEET D01 FOR ADDITIONAL INFORMATION.

NOTES:

- 1. ALL STATIONING BEYOND 61+00, IS APPROXIMATE.
- 2. DETAIL T02-26A MODIFICATION. THE EDGE OF THE SPEED TABLES SHALL END IN THE MIDDLE OF THE BIKE BUFFER.
- 3. EXISTING SIGNS SHALL BE PROTECTED UNLESS OTHERWISE NOTED.
- 4. CONTRACTOR SHALL CALL FOR UTILITY LOCATES PRIOR TO INSTALLATION OF ANY SIGNS.

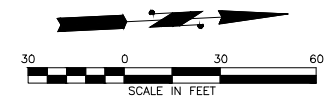

Otak, Inc.
700 Washington St., Suite 300
Vancouver, WA 98660
360.737.9613
www.otak.com



CALL
2 BUSINESS DAYS
BEFORE YOU DIG
1-800-424-5555
"It's the Law"
CLARK COUNTY UTILITIES COORDINATING COUNCIL



PUBLIC WORKS
TRANSPORTATION
P.O. BOX 1995
VANCOUVER, WA
98668-1995
360-487-7750
FAX: 360-487-4781

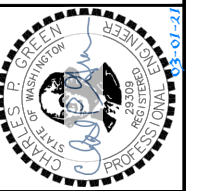

DESIGNED BY: CPG	DATE: MARCH 2021
DRAWN BY: RMS	
CHECKED BY: PJH	
APPROVED BY: CPG	
REVISIONS	
DATE	No.

COLUMBIA STREET PAVING PROJECT
13TH ST. TO 45TH ST.
STRIPING PLANS
27TH - 33RD

PROJECT NUMBER
072821
ACTIVITY CODE
ACT00937
SS03
08 OF 12

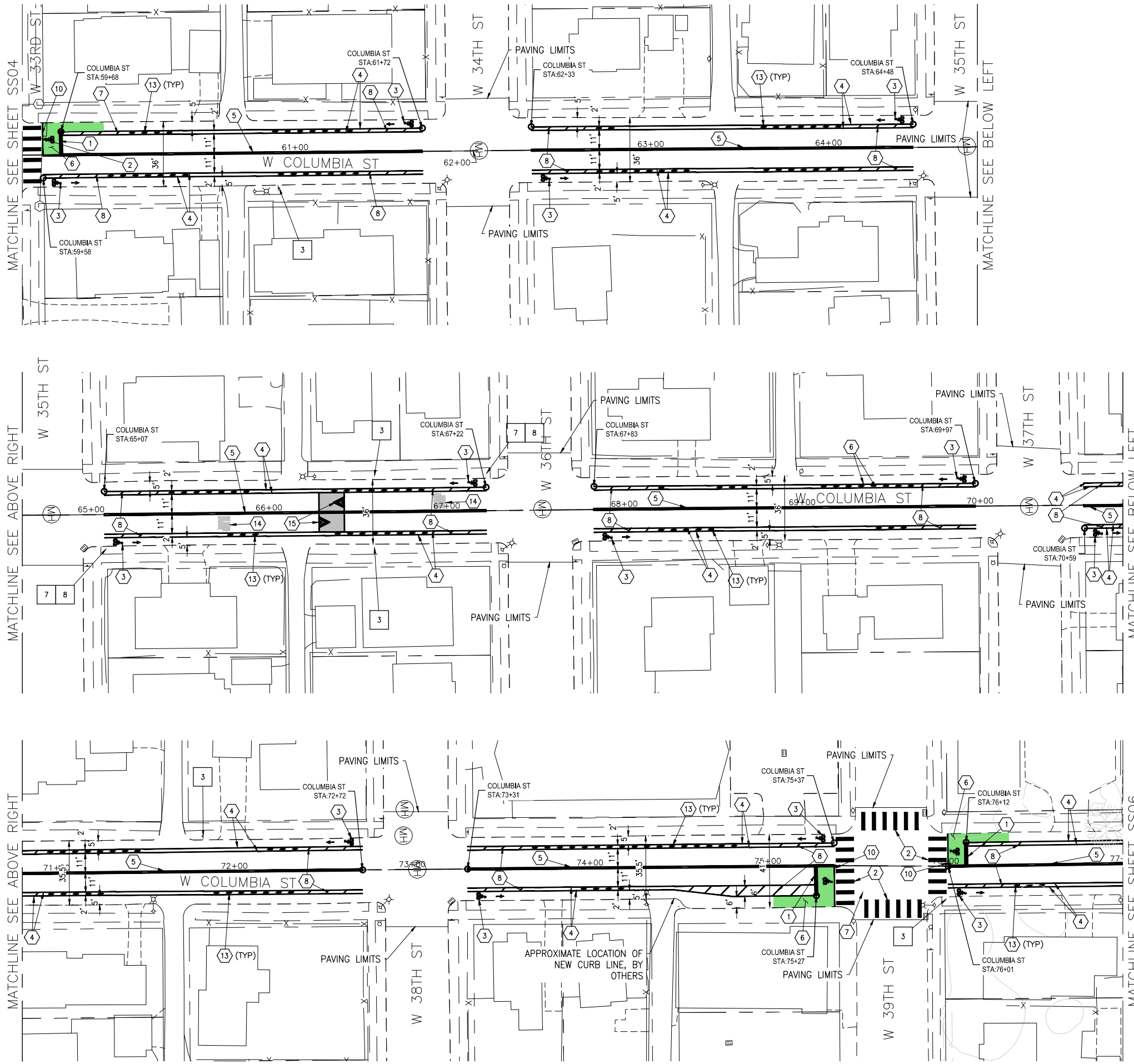

CONSTRUCTION NOTES

- ① THERMOPLASTIC STOP BAR, 24" WHITE, SEE DETAIL T29-40.
 - ② THERMOPLASTIC STANDARD CROSSWALK, SEE DETAIL T29-41.
 - ③ THERMOPLASTIC BICYCLE LANE MARKING, WHITE, SEE DETAIL T29-43.
 - ④ PAINTED BIKE LANE BUFFER ZONE, 8" ADJACENT TO TRAFFIC LANE, AND 4" ADJACENT TO BIKE LANE, SEE DETAIL T29-43.
 - ⑤ PAINTED DOUBLE YELLOW CENTER LINE MARKINGS, 4" YELLOW, SEE DETAIL T29-48.
 - ⑥ BIKE BOX, BY OTHERS.
 - ⑦ NOT USED, THIS SHEET.
 - ⑧ THERMOPLASTIC BIKE LANE BUFFER ZONE AREA MARKING. SEE DETAIL T29-43.
 - ⑨ NOT USED, THIS SHEET.
 - ⑩ PAINTED BIKE EDGE LINE, 4" WHITE, BY OTHERS.
 - ⑪ NOT USED, THIS SHEET.
 - ⑫ NOT USED, THIS SHEET.
 - ⑬ CYCLE LANE SEPARATOR, BY OTHERS.
 - ⑭ THERMOPLASTIC BUMP LEGEND, SEE DETAIL T29-42.
 - ⑮ CONSTRUCT SPEED TABLE, WITH THERMOPLASTIC TRIANGLE SPEED BUMP LEGEND, SEE DETAIL T29-42 AND DETAIL ON SHEET D01.
 - ⑯ NOT USED, THIS SHEET.
- SEE SHEET D01 FOR DETAILS.

SIGNAGE AND CONSTRUCTION NOTES:

- 1 NOT USED, THIS SHEET.
- 2 NOT USED, THIS SHEET.
- 3 REMOVE EXISTING "BICYCLE MAY USE FULL LANE", PROTECT ANY ADDITIONAL SIGNS AND POST.
- 4 NOT USED, THIS SHEET.
- 5 NOT USED, THIS SHEET.
- 6 NOT USED, THIS SHEET.
- 7 BUMP WARNING SIGN (W8-1) PER MUTCD. SEE SIGN TABLE ON SHEET D01 FOR ADDITIONAL INFORMATION.
- 8 BUMP 20 MPH ADVISORY SPEED PLAQUE (W13-1P) PER MUTCD. SEE SIGN TABLE ON SHEET D01 FOR ADDITIONAL INFORMATION.

NOTES:

- 1. ALL STATIONING BEYOND 61+00, IS APPROXIMATE.
- 2. DETAIL T02-26A MODIFICATION. THE EDGE OF THE SPEED TABLES SHALL END IN THE MIDDLE OF THE BIKE BUFFER.
- 3. EXISTING SIGNS SHALL BE PROTECTED UNLESS OTHERWISE NOTED.
- 4. CONTRACTOR SHALL CALL FOR UTILITY LOCATES PRIOR TO INSTALLATION OF ANY SIGNS.

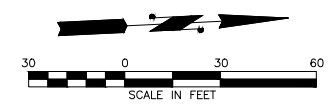

Otak, Inc.
700 Washington St., Suite 300
Vancouver, WA 98660
360.737.9613
www.otak.com

CALL
2 BUSINESS DAYS
BEFORE YOU DIG
1-800-424-5555
"It's the Law"
CLARK COUNTY UTILITIES COORDINATING COUNCIL



PUBLIC WORKS
TRANSPORTATION
P.O. BOX 1995
VANCOUVER, WA
98668-1995
360-487-7750
FAX: 360-487-4781

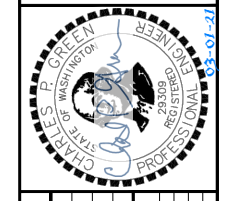

DRAWING NUMBER: SS00-SS03.DWG	DATE: MARCH 2021
DESIGNED BY: CPG	DRAWN BY: RMS
CHECKED BY: PJH	APPROVED BY: CPG
SCALE	REVISIONS
HORIZONTAL: AS SHOWN	DATE
VERTICAL:	No.

COLUMBIA STREET PAVING PROJECT
13TH ST. TO 45TH ST.
STRIPING PLANS
33RD - 39TH

PROJECT NUMBER
072821
ACTIVITY CODE
ACT00937
SS04
9 OF 12

V:\PROJECT\18700\18727\CADD\ACAD\DWG\33RD-45TH_SS.DWG

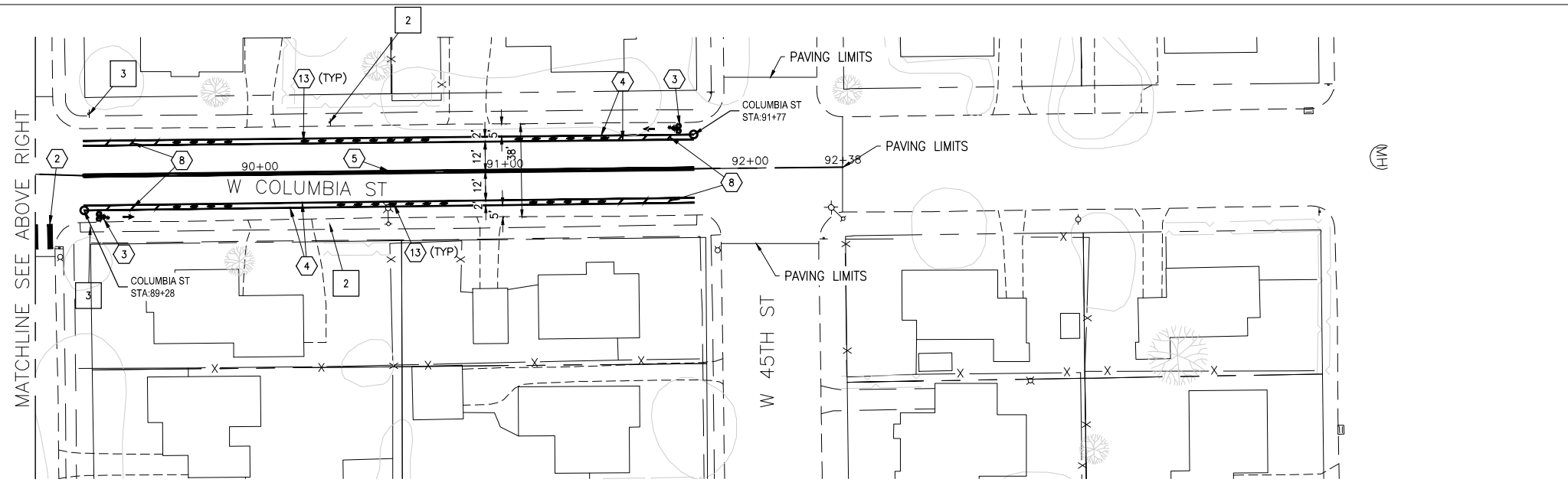
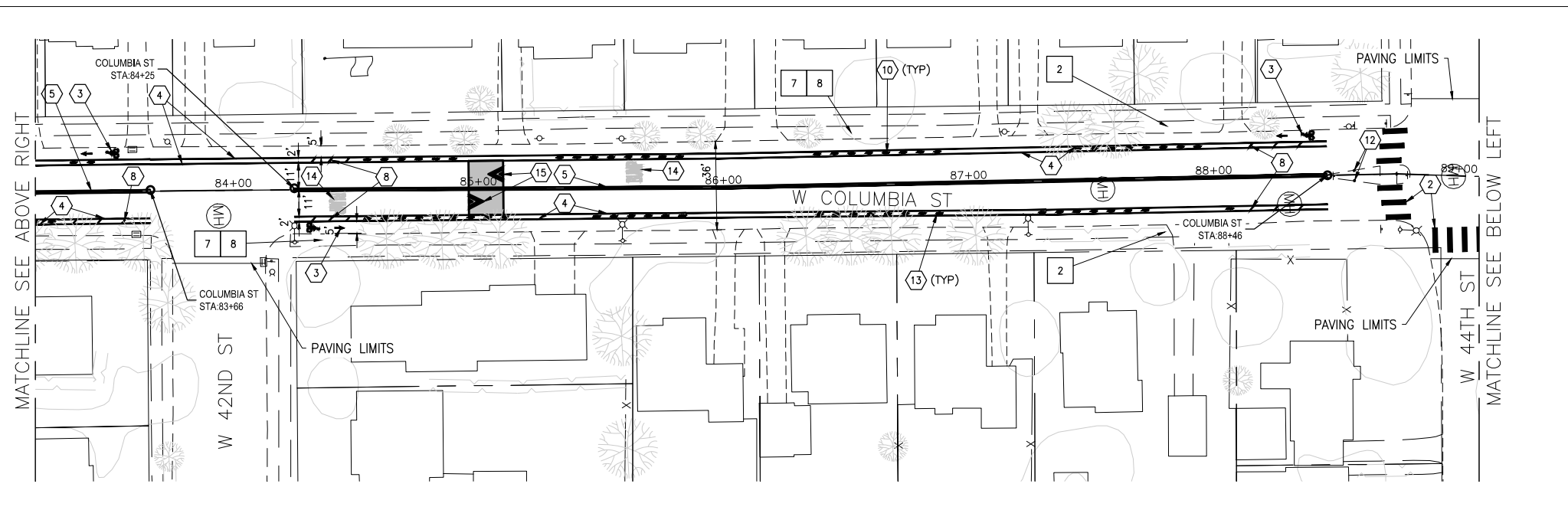
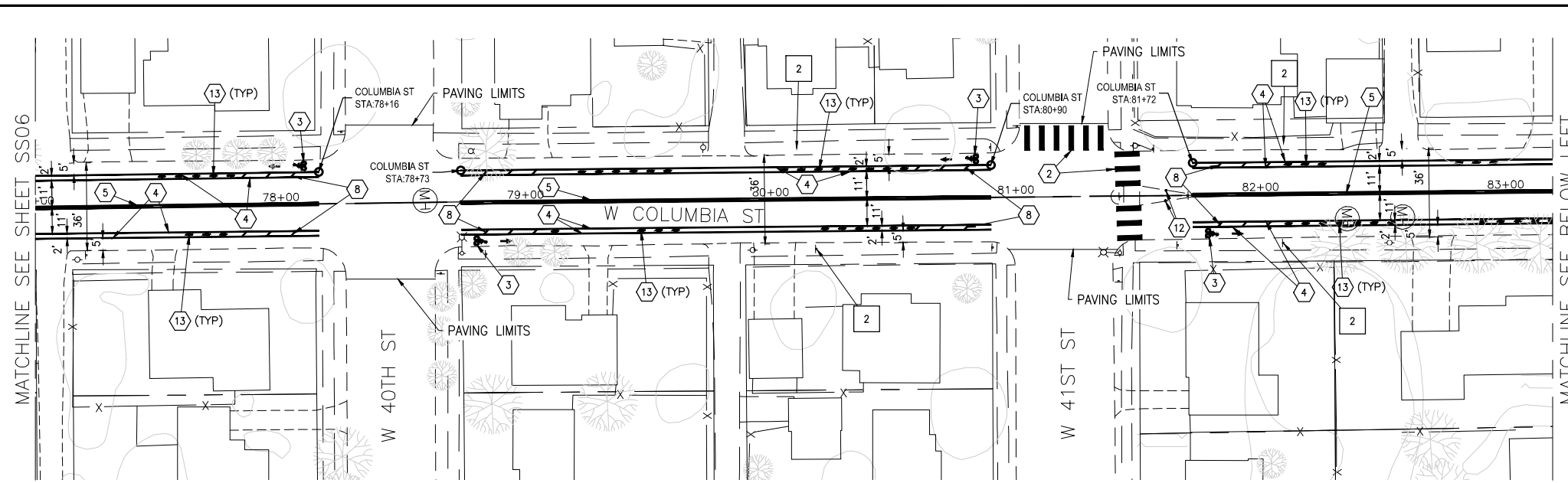

CONSTRUCTION NOTES

- ① NOT USED, THIS SHEET.
 - ② THERMOPLASTIC STANDARD CROSSWALK, SEE DETAIL T29-41.
 - ③ THERMOPLASTIC BICYCLE LANE MARKING, WHITE, SEE DETAIL T29-43.
 - ④ PAINTED BIKE LANE BUFFER ZONE, 8" ADJACENT TO TRAFFIC LANE, AND 4" ADJACENT TO BIKE LANE, SEE DETAIL T29-43.
 - ⑤ PAINTED DOUBLE YELLOW CENTER LINE MARKINGS, 4" YELLOW, SEE DETAIL T29-48.
 - ⑥ NOT USED, THIS SHEET.
 - ⑦ NOT USED, THIS SHEET.
 - ⑧ THERMOPLASTIC BIKE LANE BUFFER ZONE AREA MARKING. SEE DETAIL T29-43.
 - ⑨ NOT USED, THIS SHEET.
 - ⑩ NOT USED, THIS SHEET.
 - ⑪ NOT USED, THIS SHEET.
 - ⑫ NOT USED, THIS SHEET.
 - ⑬ CYCLE LANE SEPARATOR, BY OTHERS.
 - ⑭ THERMOPLASTIC BUMP LEGEND, SEE DETAIL T29-42.
 - ⑮ CONSTRUCT SPEED TABLE, WITH THERMOPLASTIC TRIANGLE SPEED BUMP LEGEND, SEE DETAIL T29-42 AND DETAIL ON SHEET D01.
 - ⑯ INSTALL TYPE 2YY REFLECTORS ON RAISED MEDIAN, SEE DETAIL T29-20.
- SEE SHEET D01 FOR DETAILS.

SIGNAGE AND CONSTRUCTION NOTES:

- 1 NOT USED, THIS SHEET.
- 2 REMOVE EXISTING PARKING SIGN. PROTECT ANY ADDITIONAL SIGNS AND POST.
- 3 REMOVE EXISTING "BICYCLE MAY USE FULL LANE", PROTECT ANY ADDITIONAL SIGNS AND POST.
- 4 NOT USED, THIS SHEET.
- 5 NOT USED, THIS SHEET.
- 6 NOT USED, THIS SHEET.
- 7 BUMP WARNING SIGN (W8-1) PER MUTCD. SEE SIGN TABLE ON SHEET D01 FOR ADDITIONAL INFORMATION.
- 8 BUMP 20 MPH ADVISORY SPEED PLAQUE (W13-1P) PER MUTCD. SEE SIGN TABLE ON SHEET D01 FOR ADDITIONAL INFORMATION.

NOTES:

- 1. ALL STATIONING BEYOND 61+00, IS APPROXIMATE.
- 2. DETAIL T02-26A MODIFICATION. THE EDGE OF THE SPEED TABLES SHALL END IN THE MIDDLE OF THE BIKE BUFFER.
- 3. EXISTING SIGNS SHALL BE PROTECTED UNLESS OTHERWISE NOTED.
- 4. CONTRACTOR SHALL CALL FOR UTILITY LOCATES PRIOR TO INSTALLATION OF ANY SIGNS.

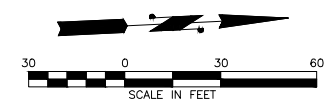

Otak, Inc.
700 Washington St., Suite 300
Vancouver, WA 98660
360.737.9613
www.otak.com

CALL
2 BUSINESS DAYS
BEFORE YOU DIG
1-800-424-5555
"It's the Law"
CLARK COUNTY UTILITIES COORDINATING COUNCIL



PUBLIC WORKS
TRANSPORTATION
P.O. BOX 1995
VANCOUVER, WA
98668-1995
360-487-7750
FAX: 360-487-4781



DRAWING NUMBER: SS00-SS03.DWG	DATE: MARCH 2021	DESIGNED BY: CFG	DRAWN BY: RMS	CHECKED BY: PJH	APPROVED BY: CFG
SCALE		HORIZONTAL: AS SHOWN			
		VERTICAL:			
DATE	No.	REVISIONS			

COLUMBIA STREET PAVING PROJECT
13TH ST. TO 45TH ST.
STRIPING PLANS
39TH - 45TH

PROJECT NUMBER
072821
ACTIVITY CODE
ACT00937
SS05
10 OF 12 SHEET

GENERAL EROSION PREVENTION & SEDIMENT CONTROL NOTES

1. ALL EROSION AND SEDIMENT CONTROL MEASURES SHALL BE IN PLACE AND IN WORKING CONDITION PRIOR TO ANY LAND DISTURBING ACTIVITY INCLUDING CLEARING OR GRADING. EROSION AND SEDIMENT CONTROL MEASURES SHALL BE APPROVED BY THE CITY EROSION SPECIALIST PRIOR TO THE COMMENCEMENT OF WORK. AN ON-SITE INSPECTION SHALL BE REQUESTED WHEN EROSION AND SEDIMENT CONTROL MEASURES ARE IN PLACE AND PRIOR TO COMMENCEMENT OF WORK. ONCE APPROVED, THE SITE MUST BE MAINTAINED THROUGH THE LIFE OF THE PROJECT, AS SHOWN ON THE PLANS. ADDITIONAL MEASURES MAY BE REQUIRED TO MEET THE PROVISIONS OF THE CITY EROSION PREVENTION AND SEDIMENT CONTROL ORDINANCE VMC 14.24.
 2. EROSION AND SEDIMENT CONTROL BMPs SHALL BE SITED, DESIGNED AND CONSTRUCTED IN ACCORDANCE WITH THE REQUIREMENTS IN THE CITY OF VANCOUVER'S LATEST VERSION OF GENERAL REQUIREMENTS AND STANDARD DETAILS MANUAL AND THE WASHINGTON STATE DEPARTMENT OF ECOLOGY STORMWATER MANAGEMENT MANUAL FOR WESTERN WASHINGTON, WHERE THE CITY OF VANCOUVER GENERAL REQUIREMENTS SHALL TAKE PRECEDENCE.
 3. THE DEVELOPER AND/OR OWNER IS RESPONSIBLE FOR MAINTAINING EROSION PREVENTION AND SEDIMENT CONTROL BMPs DURING AND AFTER INSTALLATION OF ALL UTILITY WORK ASSOCIATED WITH UTILITY TRENCHES.
 4. PRIOR TO ANY SITE EXCAVATION, ALL STORM DRAIN INLETS SHALL BE PROTECTED DOWN SLOPE FROM ANY DISTURBED OR CONSTRUCTION AREAS PER STANDARD DETAIL E-2.20 TO PREVENT SEDIMENT FROM ENTERING THE STORM DRAINAGE SYSTEM PRIOR TO PERMANENT STABILIZATION OF THE DISTURBED AREAS. CLEAN INLET FILTER AS NECESSARY TO MAINTAIN DRAINAGE, REMOVE FILTER AND CLEAN CATCH BASINS FOLLOWING COMPLETION OF SITE WORK.
 5. NEWLY CONSTRUCTED OR MODIFIED INLETS AND CATCH BASINS SHALL BE PROTECTED FROM SEDIMENT IMMEDIATELY UPON INSTALLATION.
 6. THE CONTRACTOR SHALL NOT ALLOW SEDIMENT OR DEBRIS TO ENTER NEW OR EXISTING PIPES, CATCH BASINS OR INFILTRATION SYSTEMS. IF THIS OCCURS, THE CONTRACTOR SHALL REMOVE ALL ACCUMULATED SEDIMENT FROM THE CATCH BASINS, DRYWELLS, AND STORM PIPES IMMEDIATELY. FINAL ACCEPTANCE WILL NOT BE ISSUED BY THE CITY UNTIL THIS OCCURS.
 7. PRIOR TO LEAVING A CONSTRUCTION SITE OR PRIOR TO DISCHARGING INTO AN INFILTRATION SYSTEM, SEDIMENT-LADEN WATER SHALL PASS THROUGH A SEDIMENT POND, TRAP, OR OTHER APPROVED BMP SYSTEM.
 8. ALL EXPOSED AND UNWORKED SOILS SHALL BE STABILIZED BY THE APPROPRIATE BEST MANAGEMENT PRACTICES (BMPs). FROM OCTOBER 1 TO APRIL 30, NO SOILS SHALL BE EXPOSED AND UNWORKED FOR MORE THAN TWO (2) DAYS. FROM MAY 1 TO SEPTEMBER 30, NO SOILS SHALL BE EXPOSED AND UNWORKED FOR MORE THAN SEVEN (7) DAYS.
 9. SOIL STOCKPILES SHALL BE STABILIZED FROM EROSION, PROTECTED WITH SEDIMENT TRAPPING MEASURES, AND WHEN POSSIBLE, BE LOCATED AWAY FROM STORM DRAIN INLETS, WATER WAYS AND DRAINAGE CHANNELS.
 10. CONSTRUCTION ROADS AND PARKING AREAS SHALL BE STABILIZED WHEREVER THEY ARE CONSTRUCTED, WHETHER PERMANENT OR TEMPORARY, FOR THE USE OF CONSTRUCTION TRAFFIC.
 11. IF THE BMPs APPLIED TO A SITE ARE INSUFFICIENT TO PREVENT SEDIMENT FROM REACHING WATER BODIES, ADJACENT PROPERTIES, STORM FACILITIES OR PUBLIC RIGHT-OF-WAY, THEN THE CITY SHALL REQUIRE ADDITIONAL BMPs.
 12. IF THE CITY INSPECTOR OR ENGINEER(S) HAS EVIDENCE OF POOR CONSTRUCTION PRACTICES OR IMPROPER EROSION PREVENTION BMPs, CITATIONS AND /OR A STOP WORK ORDER SHALL BE ISSUED UNTIL PROPER MEASURES HAVE BEEN TAKEN AND APPROVED BY THE CITY OF VANCOUVER.
- PROTECTION OF ADJACENT PROPERTIES, ROADS/STREETS AND PAVED SURFACES**
13. PROVIDE A 12-INCH DEEP PAD OR CRUSHED ROCK FOR A DISTANCE OF 100 FEET INTO THE SITE FOR ALL ACCESS POINTS UTILIZED BY CONSTRUCTION EQUIPMENT AND TRUCKS. PAD WIDTH SHALL BE A MINIMUM OF 20 FEET. ALL VEHICLES LEAVING THE SITE SHALL CROSS THE PAD. ACCUMULATED SEDIMENT SHALL BE PERIODICALLY REMOVED. OR ADDITIONAL ROCK SHALL BE PLACED UPON THE PAD SURFACE. ROCK SHALL BE CLEAN 4-INCH TO 8-INCH QUARRY SPALLS. ALL MATERIALS SPILLED, DROPPED, WASHED OR TRACKED FROM VEHICLES ONTO ROADWAYS OR INTO STORM DRAINS SHALL BE REMOVED IMMEDIATELY. MECHANICAL BROOM SWEEPERS ARE NOT ALLOWED.
 14. IF SEDIMENT, MUD OR DEBRIS IS TRANSPORTED ONTO A PAVED SURFACE OR ROADWAY, THE PAVED SURFACES SHALL BE THOROUGHLY CLEANED WITH HIGH EFFICIENCY STREET SWEEPERS AT THE END OF EACH WORKDAY, OR MORE OFTEN IF NECESSARY. PUBLICLY TRAVELED PAVED SURFACES NEED TO BE CLEANED IMMEDIATELY. SIGNIFICANT SOIL DEPOSITS SHALL BE REMOVED FROM ROADS BY SHOVELING AND SWEEPING. STREET WASHING IS NOT ALLOWED UNLESS APPROVED BY THE DIRECTOR AND ONLY AFTER SEDIMENT IS REMOVED IN THE MANNER DESCRIBED ABOVE. MECHANICAL BROOM SWEEPERS ARE NOT ALLOWED.
 15. SLURRY AND CUTTINGS SHALL BE VACUUMED DURING CUTTING AND SURFACING OPERATIONS. COLLECTED SLURRY AND CUTTINGS SHALL BE DISPOSED OF IN A MANNER THAT DOES NOT VIOLATE GROUNDWATER OR SURFACE WATER QUALITY STANDARDS.
 16. A WHEEL WASH MAY BE REQUIRED IF CONSTRUCTION ENTRANCE IS NOT SUFFICIENT IN PREVENTING SEDIMENT FROM BEING TRACKED ONTO PAVEMENT. WHEEL WASH SHALL BE PER STANDARD PLAN E-1.09 AND THE STORMWATER MANUAL.
 17. INSTALL SEDIMENT FENCE PER STANDARD PLAN E-2.33 PRIOR TO BUILDING CONSTRUCTION AND/OR EXCAVATION TO PREVENT SILT INTRUSION UPON ADJACENT LOTS. IF CONSTRUCTION OCCURS SIMULTANEOUSLY ON ADJACENT LOTS AND THE LOTS HAVE THE SAME OWNER DURING CONSTRUCTION, THE SILT FENCE ALONG THE COMMON LOT LINE MAY BE ELIMINATED.

GENERAL EROSION PREVENTION & SEDIMENT CONTROL NOTES (CONTINUED)

18. PROPOSED PERMEABLE PAVEMENT AREAS SHALL BE SHOWN ON THE EROSION CONTROL PLAN. PERMEABLE PAVEMENT AREAS SHALL BE PROTECTED FROM SEDIMENT DURING AND AFTER INSTALLATION, UNTIL THE DEVELOPMENT CONSTRUCTION IS COMPLETED.
 19. WASHOUT OF CONCRETE TRUCKS MUST BE PERFORMED OFF-SITE OR IN DESIGNATED CONCRETE WASHOUT AREAS ONLY. WASHING OUT CONCRETE TRUCKS, CHUTES, TOOLS OR EQUIPMENT ON THE GROUND OR INTO STORM DRAINS, OPEN DITCHES, STREETS OR STREAMS IS PROHIBITED.
 20. SUBMIT Dewatering Plan prior to discharging turbid and contaminated stormwater and groundwater off-site. TREATMENT OR DISPOSAL OPTIONS MAY INCLUDE: INFILTRATION, TRANSPORT OFF-SITE IN A VEHICLE FOR LEGAL DISPOSAL IN A MANNER THAT DOES NOT POLLUTE STATE WATERS, ECOLOGY APPROVED ON-SITE CHEMICAL TREATMENT, SANITARY OR COMBINED SEWER DISCHARGE WITH LOCAL SEWER DISTRICT APPROVAL, USE OF THE SEDIMENTATION BAG WITH OUTFALL TO A DITCH OR SWALE FOR SMALL VOLUMES OF LOCALIZED Dewatering.
 21. PERMANENT STORM WATER FACILITIES SHALL BE ISOLATED AND PROTECTED FROM SEDIMENTATION WITH AN APPROVED BMP.
- MAINTENANCE OF EROSION PREVENTION AND SEDIMENT CONTROL BMPs**
22. ALL EROSION PREVENTION AND SEDIMENT CONTROL BMPs SHALL BE REGULARLY INSPECTED AND MAINTAINED TO ENSURE CONTINUED PERFORMANCE OF THEIR INTENDED FUNCTION.
 23. THE CONTRACTOR/CE/SOL SHALL MAINTAIN AND HAVE ON-SITE A WRITTEN LOG OF EROSION PREVENTION AND SEDIMENT CONTROL BMP MAINTENANCE. CONSTRUCTION SITES SHALL BE INSPECTED AT LEAST ONCE A WEEK AND AFTER EACH RAINFALL EVENT.
 24. ALL TEMPORARY EROSION PREVENTION AND SEDIMENT CONTROL MEASURES SHALL BE REMOVED WITHIN 30 DAYS AFTER SITE STABILIZATION IS ACHIEVED OR AFTER TEMPORARY BMPs ARE NO LONGER NEEDED. TRAPPED SEDIMENT SHALL BE REMOVED OR STABILIZED ON SITE. DISTURBED SOIL AREAS RESULTING FROM REMOVAL SHALL BE PERMANENTLY STABILIZED PER THE STORMWATER MANUAL.
- DUST CONTROL**
25. IN AREAS SUBJECT TO SURFACE AND AIR MOVEMENT OF DUST, REFER TO THE STORMWATER MANUAL FOR DUST CONTROL BMPs.
- TEMPORARY SEEDING**
26. EXPOSED SURFACES THAT WILL NOT BE BROUGHT TO FINAL GRADE OR GIVEN A PERMANENT COVER TREATMENT WITHIN 30 DAYS OF THE EXPOSURE SHALL HAVE SEED MIX AND MULCH PLACED TO STABILIZE THE SOIL AND REDUCE EROSION/SEDIMENTATION. SEEDING AREAS SHALL BE CHECKED REGULARLY TO ASSURE A GOOD STAND OF GRASS IS BEING MAINTAINED. AREAS THAT FAIL TO ESTABLISH VEGETATION COVER ADEQUATE TO PREVENT EROSION WILL BE RESEED AS SOON AS SUCH AREAS ARE IDENTIFIED.
- PROTECTION OF LOW IMPACT DEVELOPMENT (LID) BMPs**
27. AN APPROVED TEMPORARY SEEDING MIXTURE SHALL BE APPLIED TO THE PREPARED SEED BED AT A RATE OF 120 LBS/ACRE. NOTE: "HYDROSEEDING" APPLICATIONS WITH APPROVED SEED-MULCH-FERTILIZER MIXTURES MAY ALSO BE USED.
 28. PROTECT ALL BIORETENTION AND RAIN GARDEN FACILITIES FROM SEDIMENTATION THROUGH INSTALLATION AND MAINTENANCE OF EROSION AND SEDIMENT CONTROL BMPs.
 29. RESTORE LID FACILITIES TO FULL FUNCTIONING CONDITION IF THEY ACCUMULATE SEDIMENT DURING CONSTRUCTION.
 30. MAINTAIN THE INFILTRATION CAPABILITIES OF BIORETENTION AND RAIN GARDEN FACILITIES BY PROTECTING AGAINST COMPACTION.
 31. CONTROL EROSION AND PREVENT SEDIMENT FROM CONTAMINATING PERMEABLE PAVEMENTS. CLEAN PERMEABLE PAVEMENT FOULED WITH SEDIMENT OR NO LONGER PASSING AN INITIAL INFILTRATION TEST.
 32. KEEP HEAVY EQUIPMENT OFF EXISTING SOILS UNDER PROPOSED LID FACILITIES THAT HAVE BEEN EXCAVATED TO FINAL GRADE TO RETAIN THE SOIL INFILTRATION RATE.
 33. CLEARING LIMITS FOR CRITICAL AREAS AND THEIR BUFFERS, AND TREES THAT ARE TO BE PRESERVED WITHIN THE CONSTRUCTION AREA SHALL BE CLEARLY MARKED PRIOR TO LAND-DISTURBING ACTIVITY.

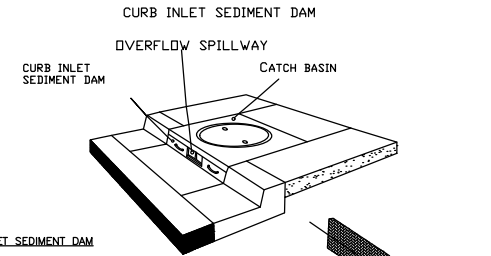

CURB INLET SEDIMENT DAM

Material: 100% Non-woven Polyfiber
 Color: Blue
 Height: 5" (Custom)
 Widths: 36" - 54" - 70" (Custom)

Installation:

Place strap through hole(s) provided. Wrap around the horizontal rod in mouth of curb inlet and extend strap through adjacent hole and tie.

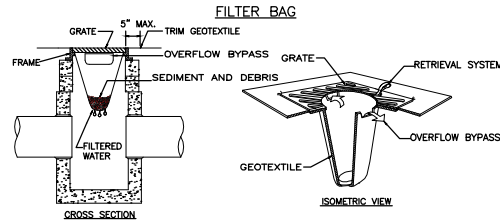

NOTES:

1. SIZE THE BELOW GRATE INLET DEVICE (BGID) FOR THE STORM WATER STRUCTURE IT WILL SERVICE.
2. THE REMOVAL SYSTEM MUST ALLOW REMOVAL OF THE BGID WITHOUT SPILLING THE COLLECTED MATERIAL.
3. THE BGID SHALL HAVE A BUILT-IN HIGH-FLOW RELIEF SYSTEM (OVERFLOW BYPASS).
4. THE CONTRACTOR SHALL INSPECT THE BAG AFTER EACH STORM EVENT AND AT REGULAR INTERVALS.
5. THE FILTER BAG SHALL BE CLEANED OR REPLACED WHEN THE BAG BECOMES HALF FULL.

N.T.S.

EROSION PREVENTION & SEDIMENT CONTROL

STANDARD PLAN NO.

CITY OF VANCOUVER
 DEPARTMENT OF PUBLIC WORKS
 SURFACE WATER MANAGEMENT

REV. NO.	DATE	BY	APPROVED
11/01/06	KAO	AMG	
08/10/09	DN	AMG	
05/15/18	DN	AMG	

E-1.00a

EROSION PREVENTION & SEDIMENT CONTROL

STANDARD PLAN NO.

CITY OF VANCOUVER
 DEPARTMENT OF PUBLIC WORKS
 SURFACE WATER MANAGEMENT

REV. NO.	DATE	BY	APPROVED
11/01/06	KAO	AMG	
08/10/09	DN	AMG	
05/15/18	DN	AMG	

E-1.00b

INLET PROTECTION DETAILS

STANDARD PLAN NO.

CITY OF VANCOUVER
 DEPARTMENT OF PUBLIC WORKS
 SURFACE WATER MANAGEMENT

REV. NO.	DATE	BY	APPROVED
06/27/04	MKH	AMG	
08/10/09	DN	AMG	
01/23/15	DN	AMG	

E-2.20a

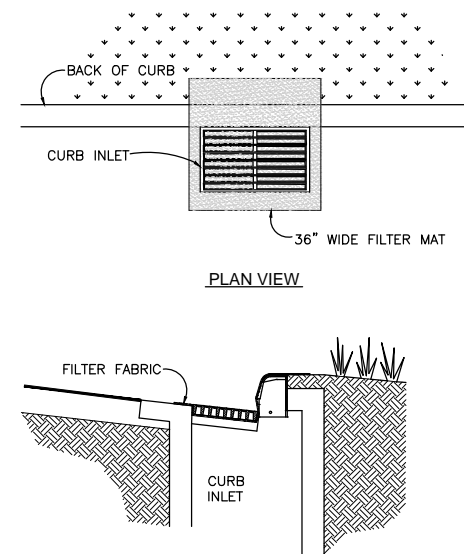

NOTES:

1. USE FILTER MAT SEDIMENT BARRIER WHEN CURB INLET IS LOCATED IN GENTLY SLOPING STREET, WITH MINIMAL NEED, WHERE WATER CAN FILTER AND ALLOW SEDIMENT TO SEPARATE FROM RUNOFF.
2. BARRIER SHALL ALLOW FOR OVERFLOW FROM SEVERE STORM EVENT.
3. INSPECT BARRIERS AND REMOVE SEDIMENT AFTER EACH STORM EVENT. SEDIMENT MUST BE REMOVED FROM THE TRAVELED WAY IMMEDIATELY.

N.T.S.

INLET PROTECTION DETAILS

STANDARD PLAN NO.

CITY OF VANCOUVER
 DEPARTMENT OF PUBLIC WORKS
 SURFACE WATER MANAGEMENT

REV. NO.	DATE	BY	APPROVED
06/27/04	MKH	AMG	
01/21/15	DN	AMG	

E-2.20b

CALL
 2 BUSINESS DAYS
 BEFORE YOU DIG
 1-800-424-5555
 "It's the Law"
 CLARK COUNTY UTILITIES COORDINATING COUNCIL

Vancover
 WASHINGTON

PUBLIC WORKS
 TRANSPORTATION
 P.O. BOX 1995
 VANCOUVER, WA
 98668-1995
 360-487-7750
 FAX: 360-487-4781

DATE: MARCH 2021	DESIGNED BY:	SCALE:
	DRAWN BY:	HORIZONTAL:
	CHECKED BY:	VERTICAL:
	APPROVED BY:	No.:
	REVISIONS:	

COLUMBIA STREET
 PAVING PROJECT
 STANDARD DETAILS

PROJECT NUMBER
072821
 ACTIVITY CODE
ACT00937
DO2
 SHEET **12** OF **12**