

THIS EXAMPLE IS NOT TO SCALE – FOR REFERENCE ONLY

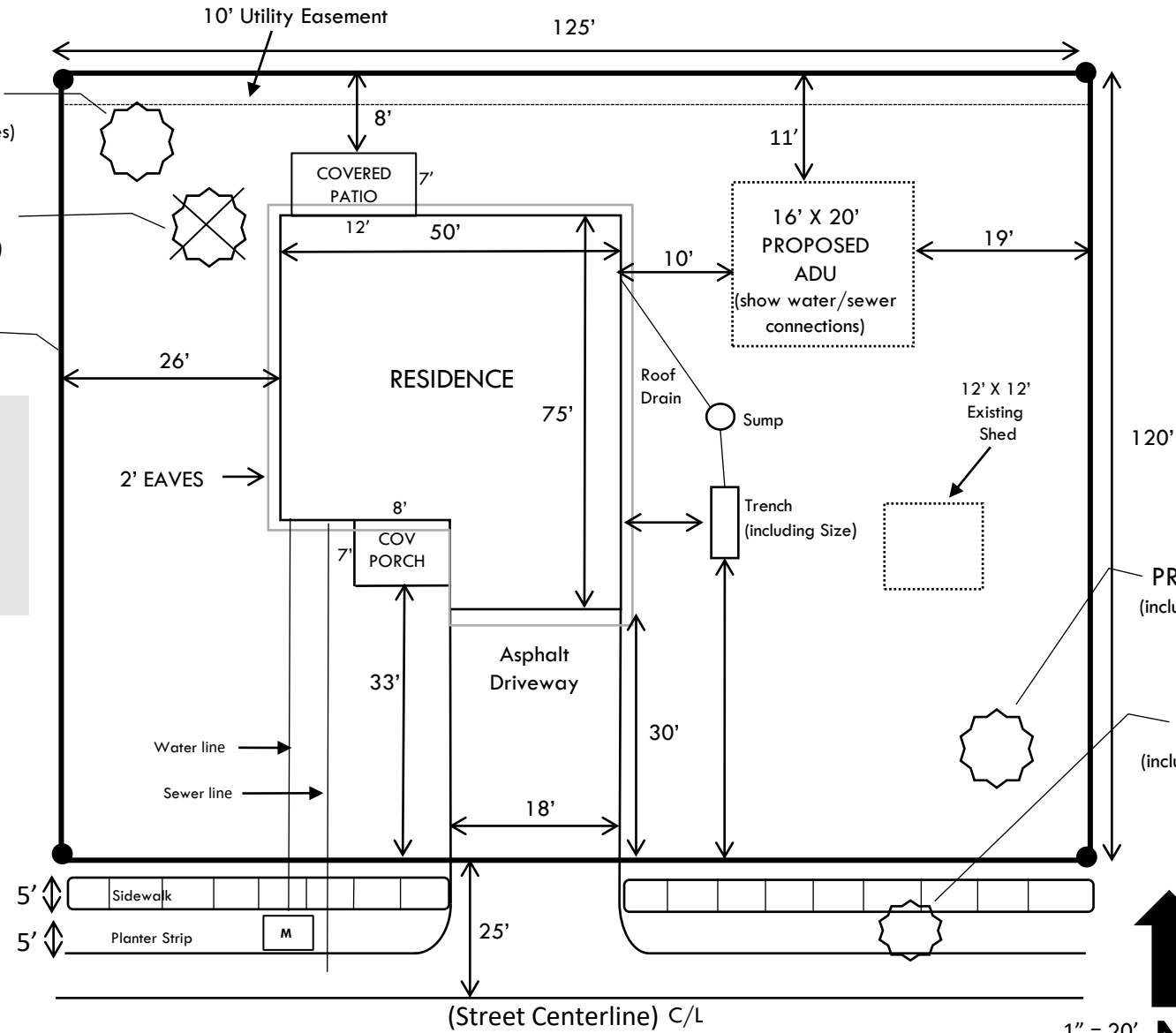

Show on-site stormwater management for roof runoff (infiltration trench, to storm lateral, Storm facility, etc.).
• Infiltration system piping and trench shall be located no closer than 5' to any property line and 10' to any structure

Show erosion control measures.
Include BMPT5.13



Address or parcel #/Subdivision Name & Lot #

Construction in the City's right-of-way (apron, wings, sidewalk, etc.) requires a ROW permit.

STREET NAME/ALLEY (Public or Private)

1" = 20'

